



Transport for NSW

# Warringah Freeway Upgrade Alfred Street North early work

Fact sheet | March 2021

The NSW Government's vision for Sydney is one of an integrated road and public transport network that gives you the freedom to choose how and when you get around, no matter where you live and work.

The Western Harbour Tunnel and Warringah Freeway Upgrade is a major transport infrastructure project that will make it easier, faster and safer to get around Sydney. By creating a western bypass of the Sydney CBD, the Western Harbour Tunnel will take pressure off the Sydney Harbour Bridge, Sydney Harbour Tunnel, Anzac Bridge and Western Distributor corridors to improve transport capacity in and around Sydney Harbour.

The Western Harbour Tunnel and Warringah Freeway Upgrade project, along with Beaches Link, is expected to support around 15,000 full-time equivalent jobs during construction.

## Upcoming work on Alfred Street North

Power, communications and sewer relocation work will be carried out along Alfred Street North from **6 April 2021**, weather permitting. We will be relocating services on Alfred Street North between Merlin Street and Lower Bent Street, and between Whaling Road and High Street, Rose Avenue and Winter Avenue.

## Work locations

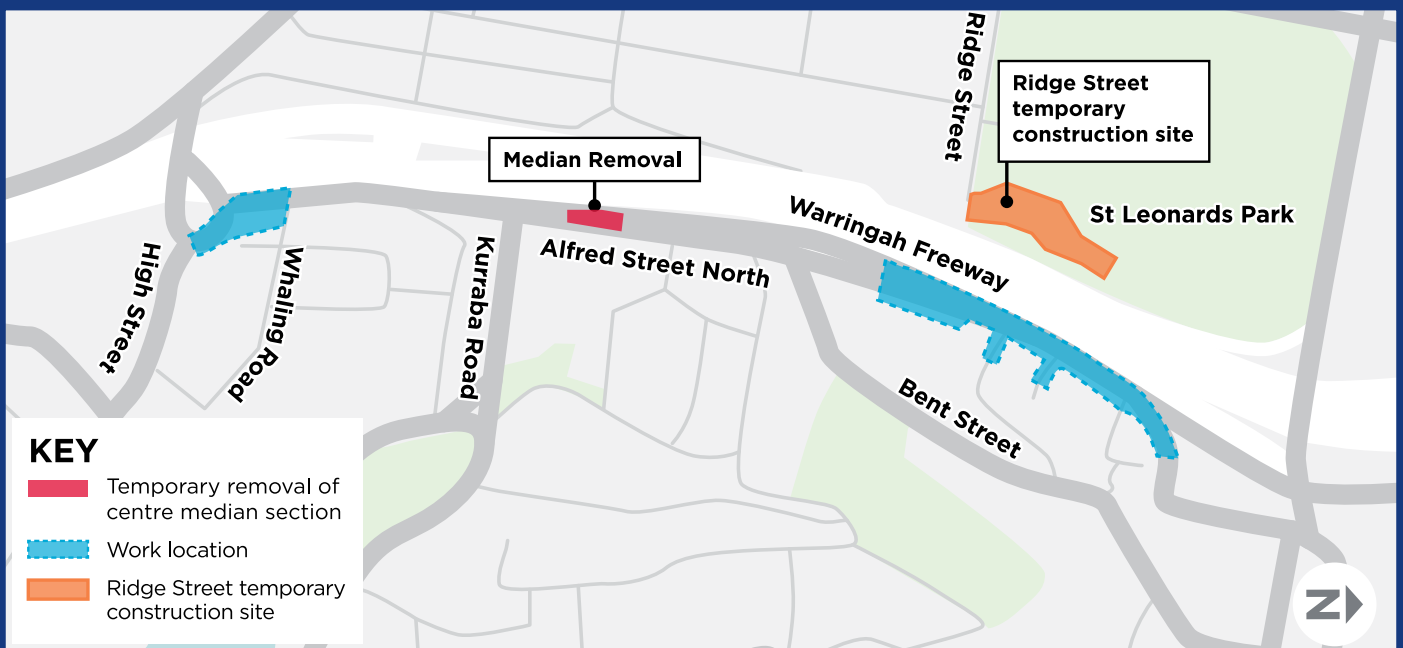

## What we will be doing

We will be:

- relocating the existing sewer line
- temporarily relocating power to prepare for and support the permanent power service work
- building a new permanent power service and relocating existing communications networks.

You will see us:

- drilling underground
- digging out pits to allow us to relocate the sewer line
- trenching
- covering pits and trenches with steel plates or backfilling at the end of each construction day
- removing some existing overhead power poles
- decommissioning a section of the existing overhead power and communications network
- putting up new street lighting and power poles

- using equipment including excavators, vacuum trucks, road saws, tipper trucks, cranes, some heavy vehicles, traffic controls and light vehicles
- installing temporary fences around our temporary construction sites so they are safely secured
- removing vegetation.

We have provided maps in this fact sheet to show you where we will be working.

You may notice vibration from some of our equipment during this work. Vibration levels will be well below the thresholds to cause damage and we will be carrying out ongoing monitoring to ensure our measures are effective in complying with our licence conditions.

There may be short-term temporary service and utility outages while this work takes place. We will notify you of any changes to your services. You will be notified well in advance of any power outages by the utility provider.

## Trenching work

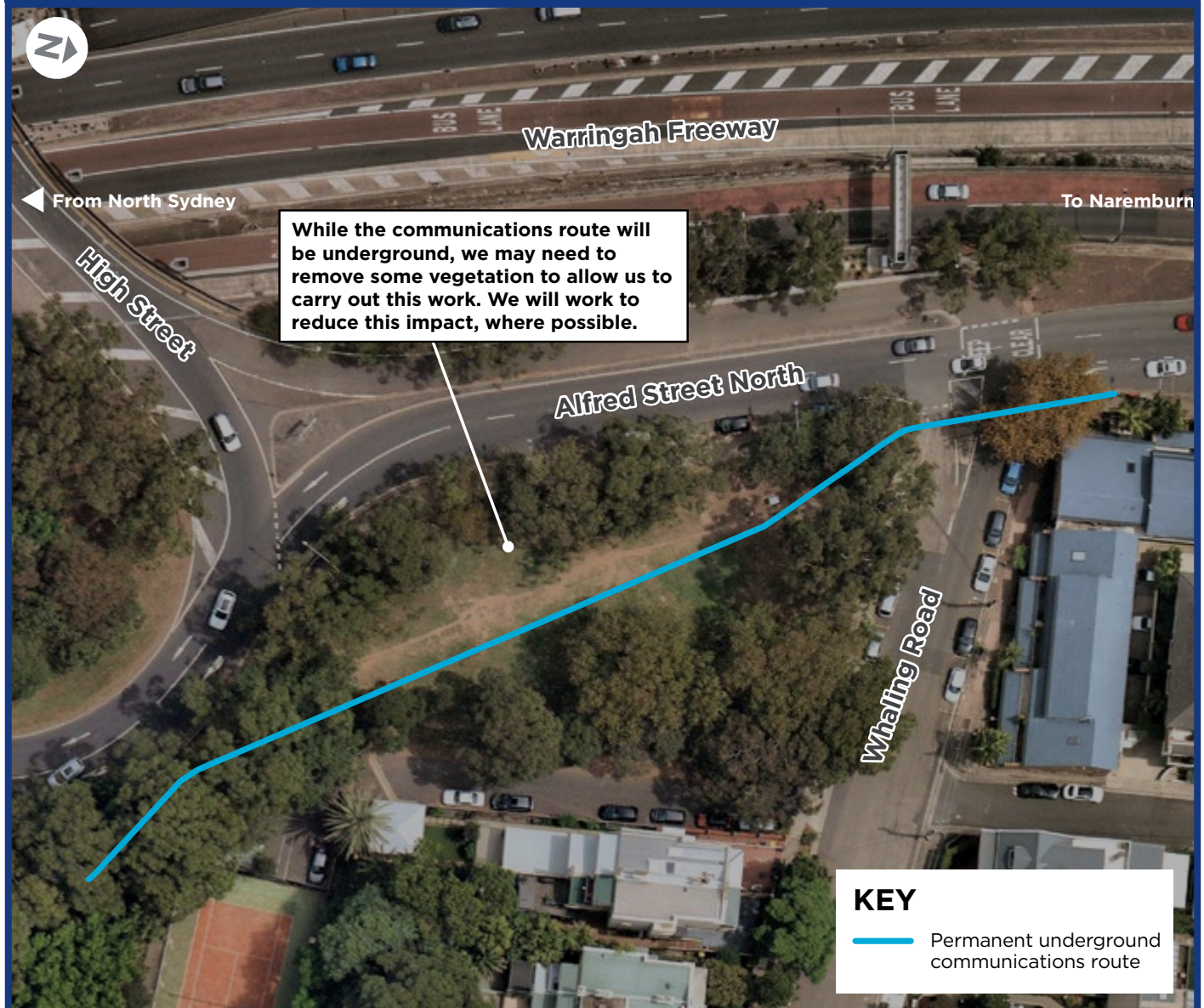

## When we will be working

Most of our work will take place during the day from **7am to 6pm Monday to Friday** and from **8am to 6pm on Saturdays**.

For the safety of the public and our workers, and to minimise traffic impacts, we may need to carry out some work at night. We will notify local residents ahead of any night work.

We have provided the table below to show the proposed duration of our work. These activities will be starting soon, weather permitting.

Work activity	Duration of work
Underground drilling for sewer line	About five weeks
Trenching for sewer line	About three months
Trenching for temporary power relocation	About three months
Building new permanent power and communications network	About six months

## Changed traffic conditions on Alfred Street North

For the next three months, when we are working, access to Alfred Street North will be restricted to local residents and their guests only. Alfred Street North will be closed to the general public and this traffic will be detoured via High and Clark Streets.

Some areas will require temporary traffic control for everyone's safety. Please keep to speed limits and follow the direction of signage and traffic controllers.

When we are not working we will re-open Alfred Street North for all traffic. Our sites will be secured and any open trenches or pits will be covered by steel plates.

All of our work zones and equipment laydown areas will be separated from local traffic, pedestrians and cyclists.

## Non-local traffic detour route during construction



# Work on Alfred Street North



From North Sydney

To Naremburn

Ridge Street pedestrian bridge

Warringah Freeway

Alfred Street North

Alfred Street North

Rose Avenue









Wyagdon Street

Winter Avenue

Bent Street

Lower Bent Street

## KEY

-  Work zone (requires the removal of some local parking)
-  Permanent underground power
-  Permanent underground communications
-  New underground sewer line
-  Sewer pit for underground drilling
-  Temporary underground power relocation
-  New power pole
-  New street light



## Changed traffic conditions on Winter Avenue

While we are working there will be temporary impacts for access to and from Winter Avenue.

At times, during sewer relocation work, Alfred Street North will be closed north of Winter Avenue. During this closure, you will be required to turn right and travel eastbound on Winter Avenue under guidance from traffic controllers. For residents on Winter Avenue, access to and from Bent Street will be managed by traffic controllers. This will be for about 10 shifts over a three month period, weather permitting.

### Sewer relocation work temporary traffic arrangements

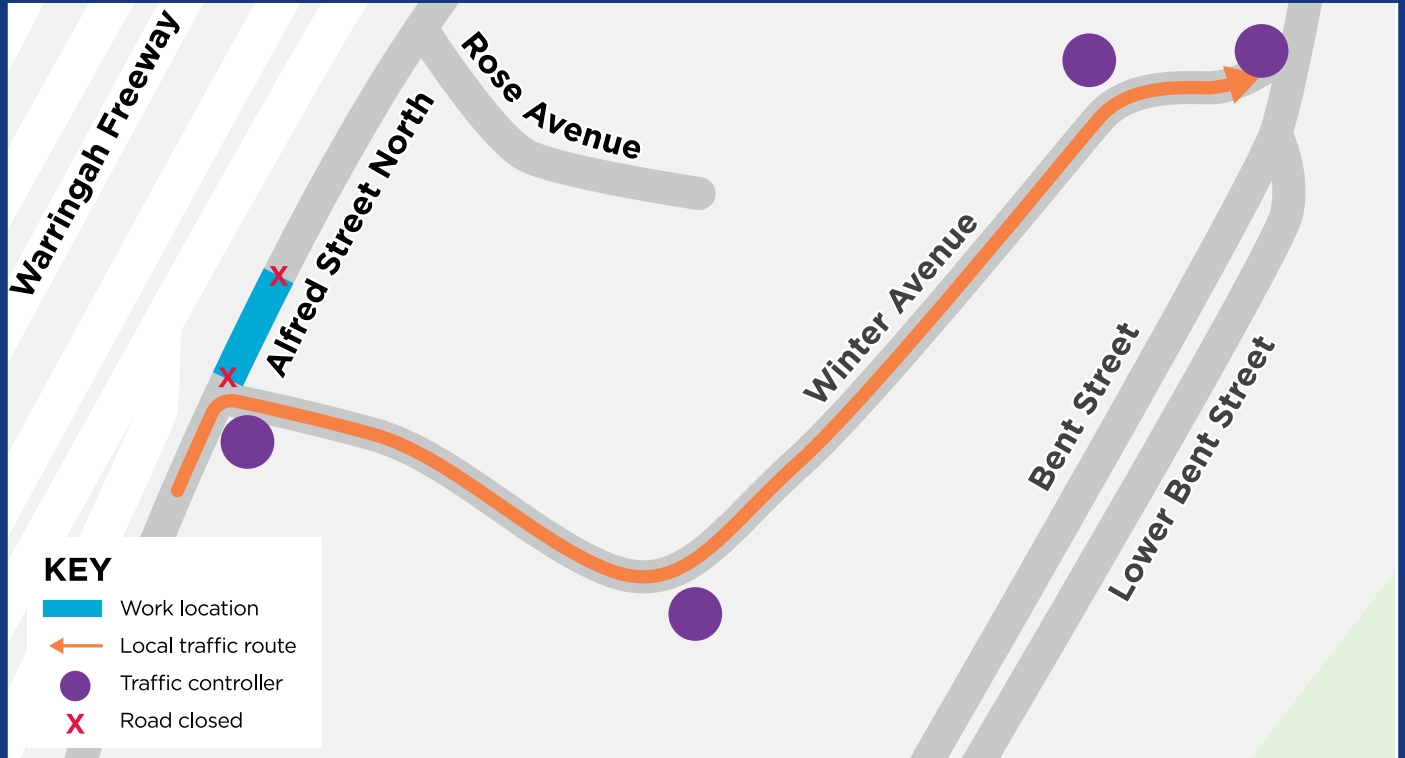

At times, during temporary and permanent power and communications work, Winter Avenue will be closed at Alfred Street North. During this closure, access to and from properties on Winter Avenue will be from Bent Street only. For residents on Winter Avenue, access to and from Bent Street will be managed by traffic controllers. This will be for about 10 shifts over an eight month period, weather permitting.

### Power and communications work temporary traffic arrangements

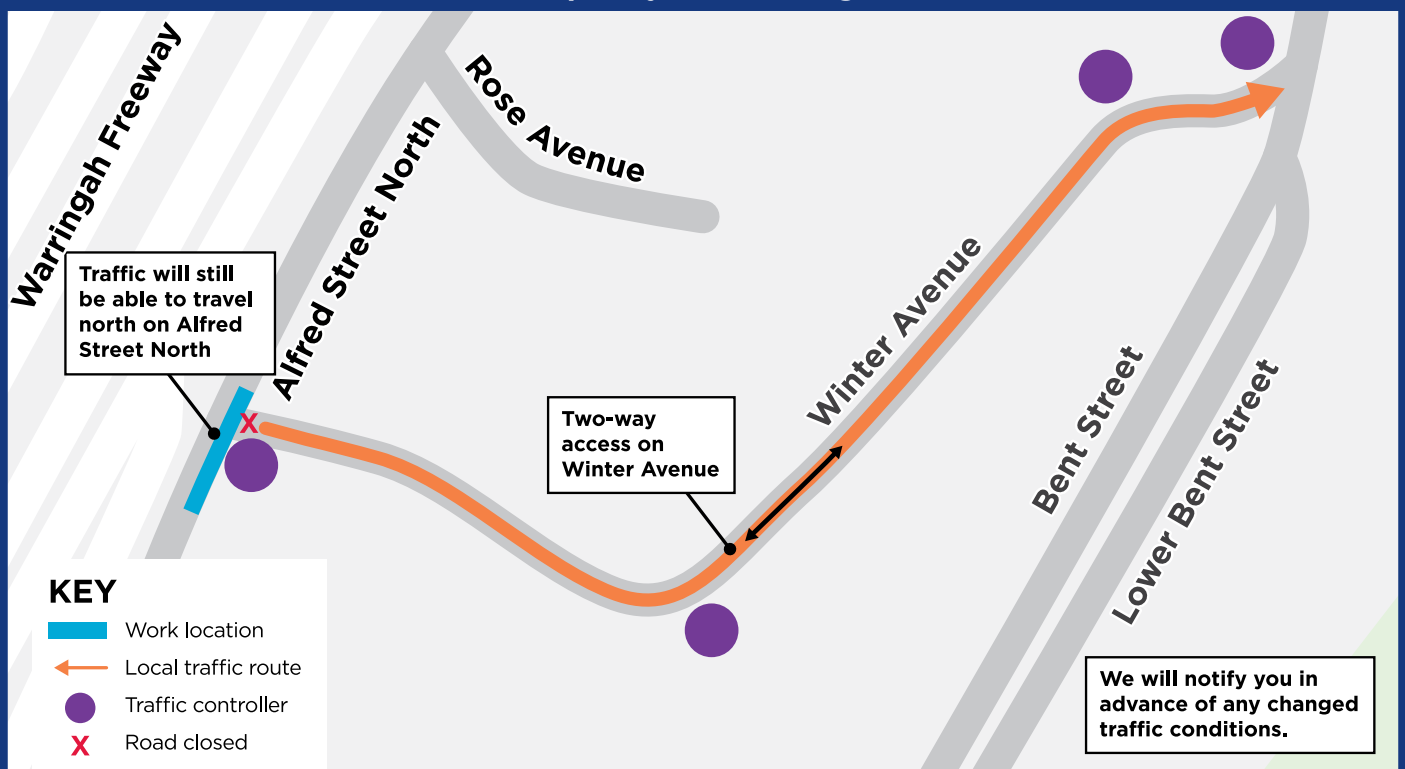

## Removal of parking spaces on Alfred Street North and Wyagdon Street

The safety of the public and our workers is our priority. To allow us to safely carry out our work and traffic changes, we will be removing about 75 parking spaces along both sides of Alfred Street North, between south of the Ridge Street pedestrian bridge and north of Rose Avenue, and on Wyagdon Street.

Our assessment found the impacts will generally be minor and can be absorbed by the surrounding network.

We are continuing to work to reduce or offset the loss of parking spaces along Alfred Street North.

We will soon be holding focused conversations and online forums to seek your input in developing additional solutions and mitigation measures to lessen the impact in your area. More information about this engagement is provided further on in this fact sheet. We encourage you to get involved in the process and let us know what we can do to support you during construction.

## Parking removal locations

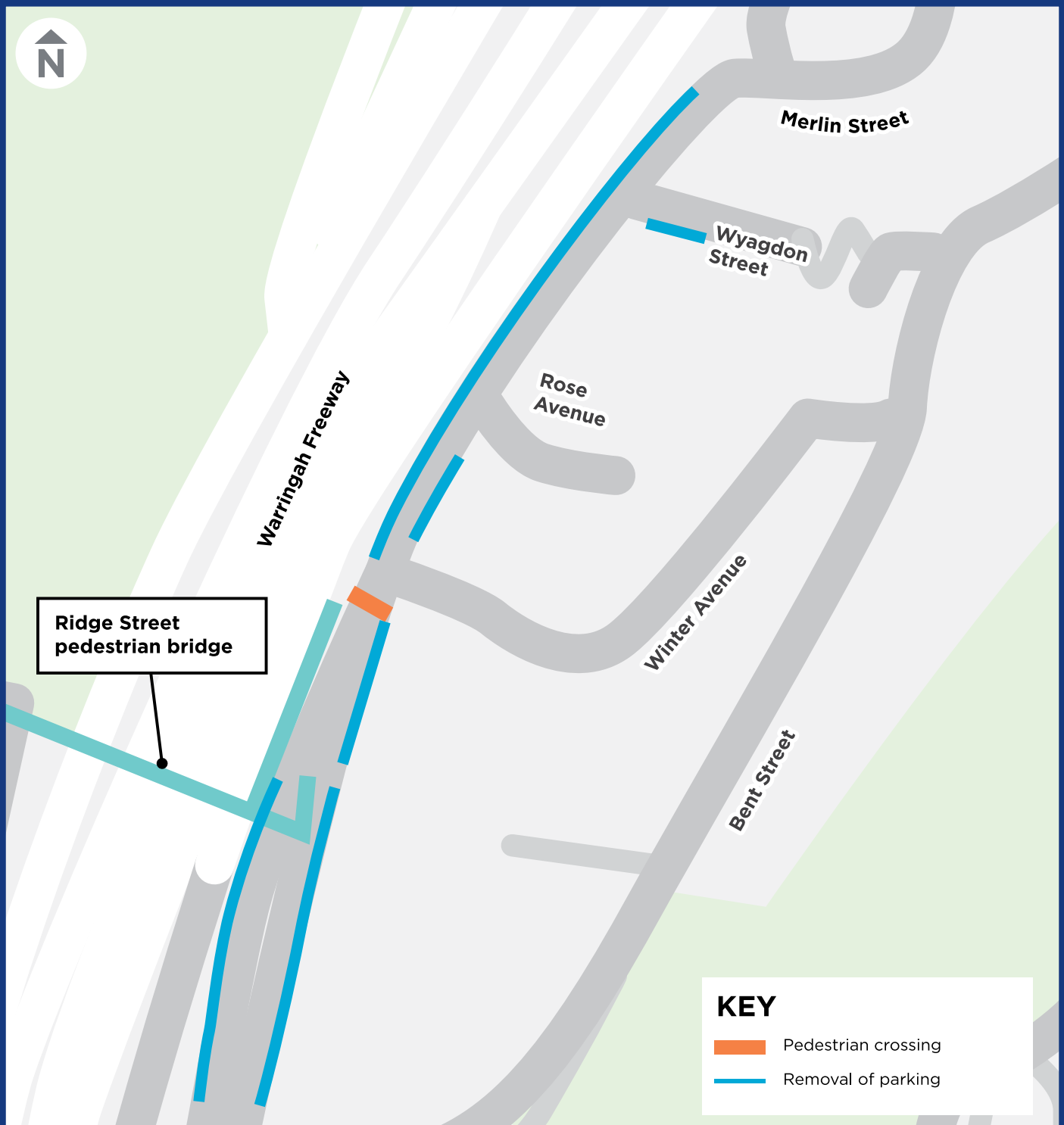

## Managing traffic

This early work will not require frequent use of large haulage trucks on Alfred Street North and Merlin Street but it will vary depending on the type of activities being carried out.

We expect there will be about 15 heavy vehicle movements per day during this work.

We will manage the potential impact of our construction traffic on the road network by:

- notifying you in advance of any changes to traffic conditions
- managing vehicle access to and from the temporary work areas for pedestrian, cyclist and motorist safety
- providing signage and line marking to direct and guide pedestrians, cyclists and motorists past our temporary work areas and around the local road network
- minimising potential truck queueing near our temporary work areas.

We will carry out partial or full road closures from 7am to 6pm Monday to Friday, 8am to 6pm Saturday or out of hours, if required.

## Managing property access

We understand this work may be disruptive and we will work closely with you to help you to continue to get to where you need to be and to minimise the impact of our work. We will:

- have traffic controllers available to assist local residents to enter and exit their properties while we carry out work
- manage the collection of rubbish bins between properties and council rubbish collection vehicles, if impacted by our work
- contact you directly if we need to temporarily impact your driveway access during our work.

## Managing pedestrian and cyclist access

Pedestrian and cyclist access will be maintained, however pedestrians and cyclists may be momentarily stopped by traffic controllers to allow for construction vehicle movements and material deliveries.

The eastern footpath on Alfred Street North between Winter Avenue and Rose Avenue will be closed during the permanent power relocation work and pedestrians will be required to use the path on the western side of Alfred Street North.

## Emergency services

Emergency services have been consulted and will be kept informed of our construction activities and changed traffic conditions. Our traffic controllers will also be onsite to support and assist emergency vehicles during all stages of our work.

## Working with you

We understand the impacts in this area may be disruptive during construction. We will be part of your community and are committed to working with you to find ways for the project team to be a better neighbour.

We are planning to start a targeted engagement program to generate new ideas about additional mitigation measures we can implement to lessen our impacts in your area.

We want to work with you to create an expanded set of mitigation measures and solutions to help support you during construction.

We will soon be holding focused conversations and online forums to seek your input in developing these additional solutions and mitigation measures. More information about this engagement will be provided in the coming weeks.

We encourage you to get involved in the process and let us know what we can do to support you during construction. To register your interest in this engagement, please call us on **1800 931 189** or email [whtbl@transport.nsw.gov.au](mailto:whtbl@transport.nsw.gov.au)

## For more information

If you would like to speak to us about our work, please call us on **1800 931 189**. You can also email us with your questions via [whtbl@transport.nsw.gov.au](mailto:whtbl@transport.nsw.gov.au).

To be kept up to date on this work or the project, please call or email us to register for updates.



If you need help understanding this information, please contact the Translating and Interpreting Service on **131 450** and ask them to call us on **1800 931 189**.

March 2021  
21.041



**Privacy** Transport for NSW is collecting your personal information in connection with Western Harbour Tunnel and Warringah Freeway Upgrade ("the Project"). In addition to collecting your name and contact details we may collect other information such as your submissions and other communications with us. We will retain and use this information for consultation purposes, including communications and analysis in connection with the Project. We will not disclose your personal information to third parties unless authorised by law and if we include your submissions in any public report we will not identify you. Providing your personal information is voluntary but if you do not provide it we may not include you on our stakeholder database and you might miss further consultation opportunities. Your personal information will be held by us and you can contact us to access or correct it. Please write to us at either [whtbl@transport.nsw.gov.au](mailto:whtbl@transport.nsw.gov.au) or Transport for NSW, Locked Bag 928, North Sydney NSW 2059. [whtbl@transport.nsw.gov.au](mailto:whtbl@transport.nsw.gov.au) or Transport for NSW, Locked Bag 928, North Sydney NSW 2059.