



Transport for NSW

Warringah Freeway Upgrade

Blue Street temporary construction site and North Sydney early work update

Notification | May 2021

The NSW Government's vision for Sydney is one of an integrated road and public transport network that gives you the freedom to choose how and when you get around, no matter where you live and work.

The Western Harbour Tunnel and Warringah Freeway Upgrade is a major transport infrastructure project that will make it easier, faster and safer to get around Sydney. By creating a western bypass of the Sydney CBD, the Western Harbour Tunnel will take pressure off the Sydney Harbour Bridge, Sydney Harbour Tunnel, Anzac Bridge and Western Distributor corridors to improve transport capacity in and around Sydney Harbour.

The Western Harbour Tunnel and Warringah Freeway Upgrade project along with Beaches Link, is expected to support around 15,000 full-time equivalent jobs during construction.

Upcoming work in North Sydney

Service and utility relocation work will be carried out throughout North Sydney **from late May 2021**, weather permitting. We will be relocating services on Arthur Street between Mount Street and Pacific Highway and at the intersection with Middlemiss Street, North Sydney.

Two existing watermain connections will be relocated as part of the construction of Warringah Freeway Upgrade. The two affected sites are located next to the Pacific Highway exit ramp near High Street and at the entry ramp from Mount Street, near Alfred Street North.

There may also be short-term temporary service and utility outages while this work takes place. Impacted properties will be notified of any power outages by the utility provider.

What we will be doing

We will be:

- relocating existing power and telecommunication services
- relocating existing water main connections
- removing redundant services.

You will see us:

- drilling underground
- digging out pits
- trenching across sections of the road or footpath
- covering pits and trenches with steel plates or backfilling at the end of each construction day; at completion the area will be reinstated
- using excavators, vacuum trucks, road saws, tipper trucks, plate compactors, cranes, some heavy vehicles, traffic control and light vehicles, among other plant and equipment,
- installing fences around our temporary construction sites so they are safely secured
- changing traffic conditions to facilitate construction work
- removing vegetation.

Work in North Sydney

Service and utility relocation work will be carried out in this area for six months. To stay updated with the latest information please see the 'upcoming work' section of the nswroads.work/whtportal



Short term worksites will be set up at locations along the alignment to undertake the work.

Building our Blue Street temporary construction site

From mid **May 2021**, we will be building a temporary site within the Sydney Trains work area at Blue Street, North Sydney. The temporary site will be located within the rail corridor and will take about two weeks to build, weather permitting. Access to the site will be via Blue Street, North Sydney.

The temporary construction site will be used until early 2022 while we relocate services and utilities in North Sydney, near the Warringah Freeway. The site will then be used to support main construction work until 2025.

The Blue Street temporary site will include a small storage area for plant and equipment, a site shed and parking for around 12 staff and construction crew.

To build the site we will need to use cranes, power tools, hand tools, diesel generator, mobile lighting towers, elevated work platforms, some heavy vehicles, traffic control and light vehicles.

While we build the site, you will see us:

- installing fencing around the temporary site for the safety of workers near the rail corridor
- building staff facilities and marking out parking spaces.

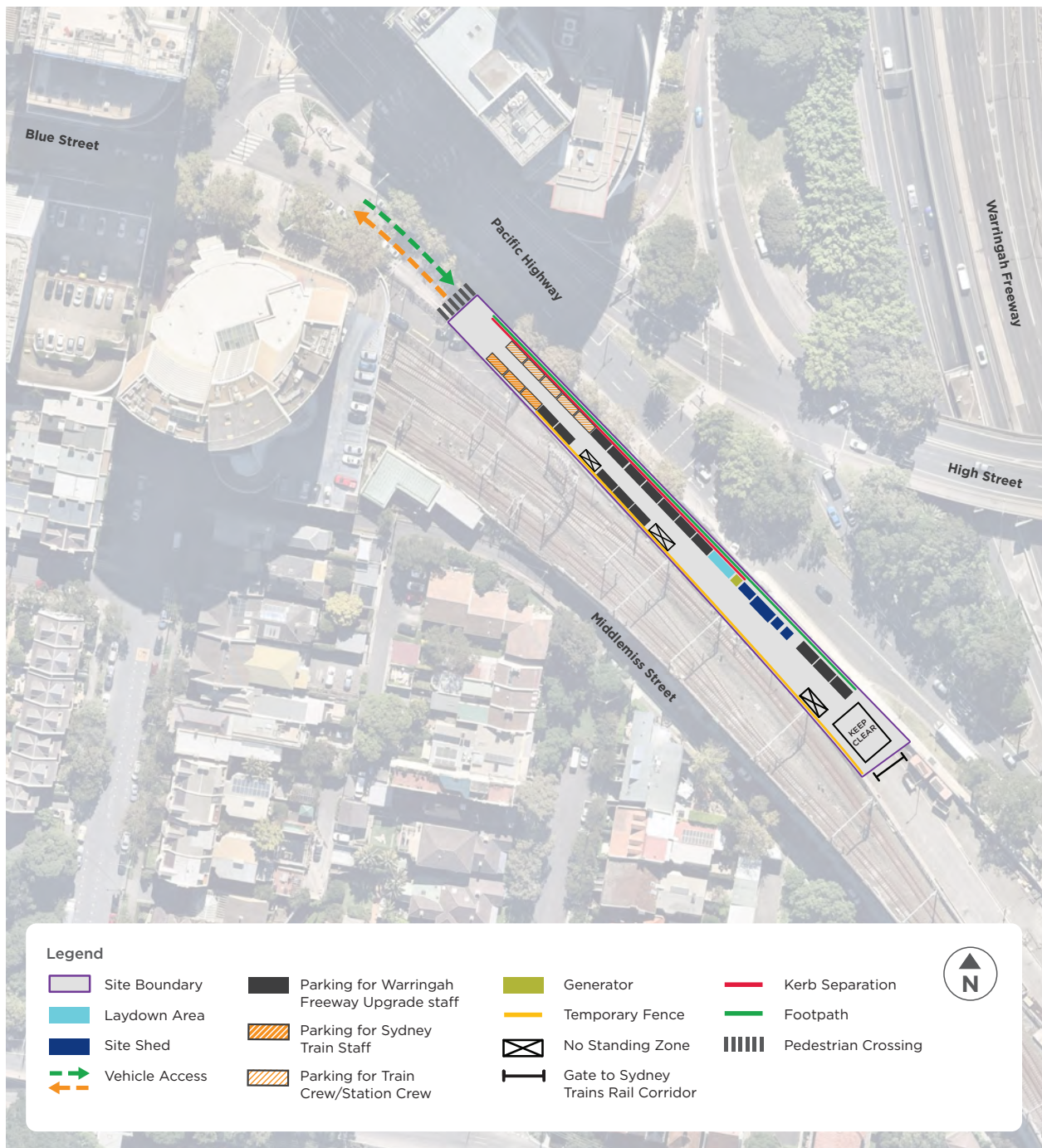

How we will access the temporary site

All construction vehicles and workers accessing the site will need to enter and exit the temporary site via Blue Street cul-de-sac. We will not access the site via the rail corridor to ensure safety for our workers and the community.

The expected maximum vehicle movements to and from the site per day during construction are shown in the table below. The actual vehicle numbers travelling to and from the site will vary depending on where we are in the construction program.

Approximate light vehicle movements per day*	Approximate heavy vehicle movements per day*
100	20

*Please note: one vehicle entering and then exiting the site is counted as two movements

When we will be working

Most of our work will take place during the day from **7am to 6pm Monday to Friday** and from **8am to 6pm on Saturdays**.

For the safety of the public and our workers, and to minimise traffic impacts, we will need to carry out some work at night. We will notify local residents ahead of any night work. We expect to be starting night work from late May.

We have provided the table below to show the proposed duration of our service and utility work, which is **scheduled to start from late-May, weather permitting**.

Work activity	Location	Duration of work
Relocate the existing water main connections	<ul style="list-style-type: none">- At the entry ramp from Mount Street, near Alfred Street North- Pacific Highway exit ramp near High Street	About four months
Remove and relocate power supply (above and below ground network)	Arthur Street between Mount Street and Pacific Highway	About six months
Remove and relocate telecommunications network	Arthur Street between Mount Street and Pacific Highway	About two months

Noise treatment

We understand noise can be a source of disruption during the construction and operation of the project.

We are delivering noise treatment to eligible properties to help reduce the impact of noise on local residents. If your property is eligible a member of a team of our team will be in touch.

For more information about how we will manage noise, including fact sheets and project documents, please visit our online portal at nswroads.work/whtportal-noise or please call us on **1800 312 772** (9am to 5pm, Monday to Friday) or you can email whtbl@transport.nsw.gov.au.

Reducing the impact on you

We have taken on your feedback to reduce the impact of our work as much as we can including creating a staff car park within the Blue Street temporary site to reduce impacts to existing commuter and on-street parking. While we will do everything we can to minimise our construction impact, you may notice periods of noise while we are building the site.

Changed traffic conditions and temporary removal of parking spaces

The safety of the public and our workers is our priority. To allow us to safely carry out our work on Arthur Street near live traffic, we will be:

- temporarily removing about three parking spaces along the southern side of Arthur Street between Pacific Highway and Middlemiss Street. Our assessment found the impacts will generally be minor and can be absorbed by the surrounding network
- temporarily closing one lane of the Warringah Freeway Mount Street on/off ramp **from Friday 28 May** for the duration of construction of the Warringah Freeway Upgrade. Motorists heading north from the Sydney Harbour Bridge/Bradfield Highway will need to use the Pacific Highway exit. Motorists heading south to the city from Arthur Street / High Street or Mount Street will continue to use either the Cahill Expressway or the remaining single lane at Mount Street southbound on-ramp to the Sydney Harbour Bridge / Bradfield Highway. **See map on the next page**
- removing the dedicated bus lane on Arthur Street (northbound) to allow all motorists to use the lane. Please see the map provided for more information about these changes
- temporarily closing Arthur Street between High Street and Mount Street for up to three nights during work to close the one lane on the Mount Street on/off ramp in late May 2021.

Details regarding all temporary detours will be provided via signage and letterbox drop to local residents and businesses in advance and will be available online on the project portal.

Managing traffic

While we are working, some areas will require temporary traffic control for everyone's safety. Motorists may experience a short delay while we are working in North Sydney. Please keep to speed limits and follow the direction of signage and traffic controllers.

The use of heavy vehicles will vary depending on the type of activities being carried out. We expect there will be up to **30 heavy vehicle movements (per shift, day or night)** during the relocation and removal of services and utilities in this area. Please note, a vehicle travelling in and out of the site is counted as two movements. You will be notified of any night work in advance.

We will manage the potential impact of our construction traffic on the road network by:

- notifying you in advance of any changes to traffic conditions
- managing vehicle access to and from our temporary sites for pedestrian, cyclist and motorist safety
- providing signage and line marking to direct and guide motorists, cyclists and pedestrians past our temporary sites and around the local road network
- minimising potential truck queueing near our temporary construction sites
- carrying out work at night to reduce impacts to high daytime traffic volumes.



For the latest traffic updates:
Call 132 701
Visit www.livetraffic.com
Download the app
Live Traffic NSW

Mount Street ramp closure

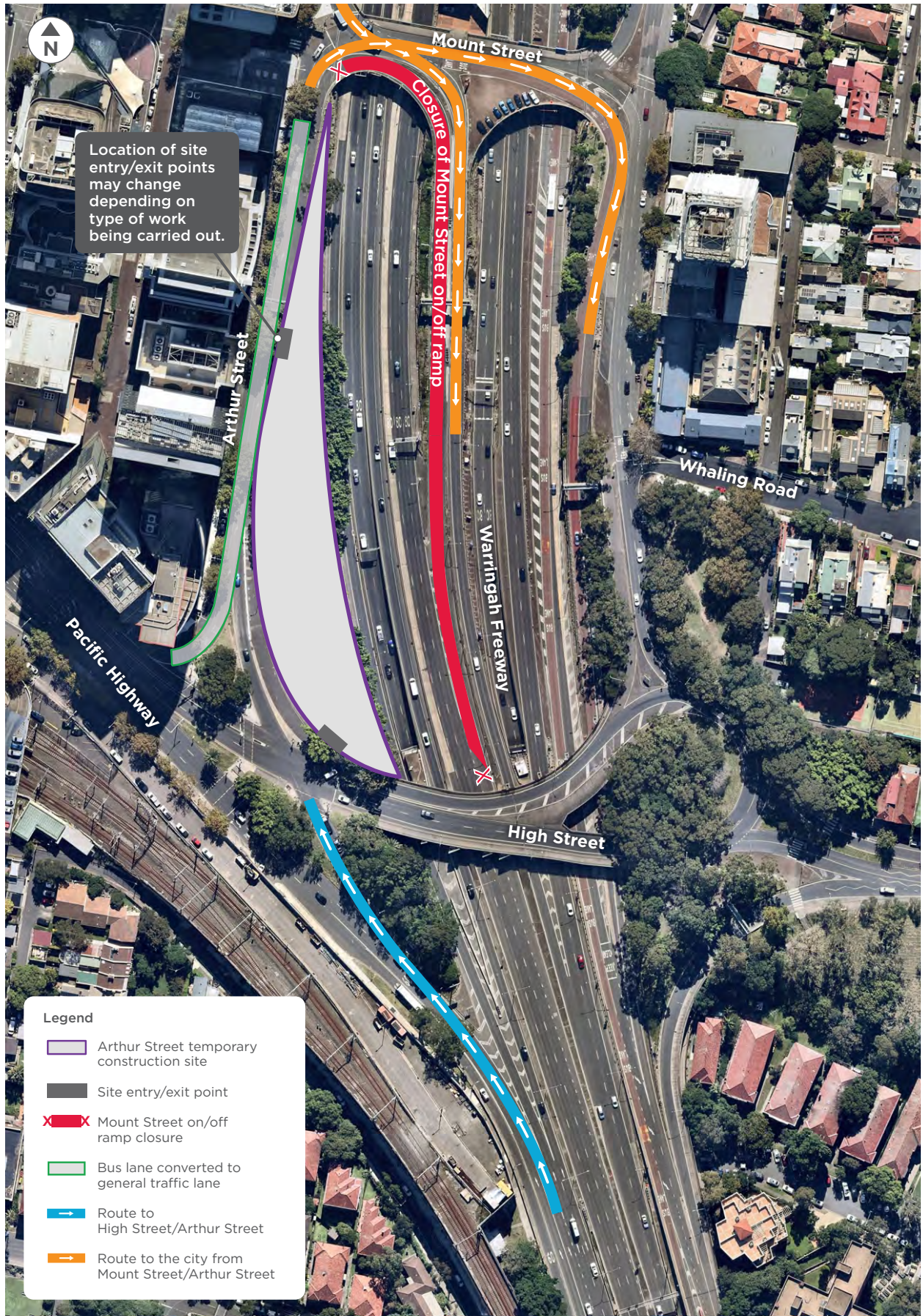

Managing noise and vibration

You may notice vibration and noise from some of our equipment during this work. We will be using a range of measures to reduce the impact of our work such as staging our work, providing additional notification and consultation about noisy work, turning off machinery and equipment when not in use, installing hoardings and temporary noise barriers, and providing alternative accommodation, where appropriate.

Vibration levels will be well below the thresholds to cause damage and we will be carrying out ongoing monitoring to ensure our measures are effective in complying with our licence conditions. We will also monitor noise from our work to ensure our mitigation measures are also effective.

We are continuing to review the way we plan and undertake work, and are interested in hearing from you about any suggestions you may have to reduce our impact. We encourage you to complete our community survey and provide your suggestions.

Managing property access

We understand this work will be disruptive at times and will work closely with you to help you to continue to get to where you need to be and to minimise the disruption of our work. We will:

- contact you directly if we need to temporarily restrict access to your driveway, as this will be required at certain times during this work
- have traffic controllers available to assist local residents and businesses enter and exit their properties while we are working
- support businesses who require loading zones at certain times during this work where we can.

Managing pedestrian and cyclist access

Pedestrian access to western side of Arthur Street (from Pacific Highway) may be restricted at times due to construction work on Arthur Street. Pedestrians may be diverted by traffic controllers to use Little Walker Street, North Sydney while work is in progress.

Signage will be in place in advance to provide information of any changes to pedestrian access.

Emergency services

Emergency services have been consulted and will be kept informed of our construction activities and changed traffic conditions. Our traffic controllers will also be onsite to support and assist emergency vehicles during all stages of our work.

Getting to know you community survey

We are continuing to build our knowledge and understanding of your community and surrounding local businesses to help us identify further ways to minimise impacts during construction. We would like to invite you to participate in a short survey so we have a greater understanding of you and your circumstances.

The information from the survey will be collated and used to identify themes and trends which we will consider when planning our work. It will also help us understand if you have a unique situation we should be aware of. The survey is voluntary and you may choose to only complete parts of it. It should take five minutes to complete.

If you have any questions relating to this survey or generally regarding the Western Harbour Tunnel and Warringah Freeway Upgrade, you can visit our portal for the latest information at nswroads.work/whtportal or contact our team at whtbl@transport.nsw.gov.au or at **1800 931 189**.

To complete the survey, please use the QR code below or visit nswroads.work/wfucommunitysurvey



Stay in touch with us



nswroads.work/whtportal



1800 931 189



whtbl@transport.nsw.gov.au



Customer feedback
Transport for NSW, Locked Bag 928
North Sydney NSW 2059



If you need help understanding this information, please contact the Translating and Interpreting Service on 131 450 and ask them to call us on 1800 931 189.

Making a complaint about our work

To make an enquiry or a complaint about the project, you can call our community information line, which is available 24 hours a day and is attended during project operation hours. Enquiries and complaints may also be received by the project email and by post.

Privacy Transport for NSW is collecting your personal information in connection with Western Harbour Tunnel and Warringah Freeway Upgrade ("the Project"). In addition to collecting your name and contact details we may collect other information such as your submissions and other communications with us. We will retain and use this information for consultation purposes, including communications and analysis in connection with the Project. We will not disclose your personal information to third parties unless authorised by law and if we include your submissions in any public report we will not identify you. Providing your personal information is voluntary but if you do not provide it we may not include you on our stakeholder database and you might miss further consultation opportunities. Your personal information will be held by us and you can contact us to access or correct it. Please write to us at either whtbl@transport.nsw.gov.au or Transport for NSW, Locked Bag 928, North Sydney NSW 2059.