

Berrys Bay Draft master plan

Consultation summary report

December 2022



Artist's impression of view from Woodley's boatyard

Executive summary	4
Document purpose	4
The project	4
How we engaged.....	4
Who we heard from.....	4
What we heard	4
Next steps	5
About the project	6
Background.....	6
Berrys Bay vision.....	6
Key features	6
Engagement activities	7
Stakeholder briefings and meetings	7
Media Release	7
Door knock.....	7
Community update and posters	7
Social media.....	8
Interactive portal and survey.....	9
Community information sessions.....	9
Email.....	9
Engagement outcomes	10
Survey Results	10
Demographics of survey respondents.....	10
Vision and proposed programming	11
Use of space features	13
Playground	15
Woodley’s Shed and the Administration Building.....	16
Features and improvements.....	17
Submissions.....	18

Community information sessions19

Community and Stakeholder Working Group (CSWG)19

Key themes..... 21

Open space21

Playground21

Car parking.....21

Heritage21

 Future use of existing buildings.....21

Water access22

 Kayak and small boat storage22

Limiting development.....22

Next steps 22

Appendix A - Community update 23

Appendix B - Community poster 24

Appendix C – Community update distribution map..... 25

Appendix D – Social media posts 26

Appendix E – Survey questions..... 27

Appendix F – Community update emails..... 30

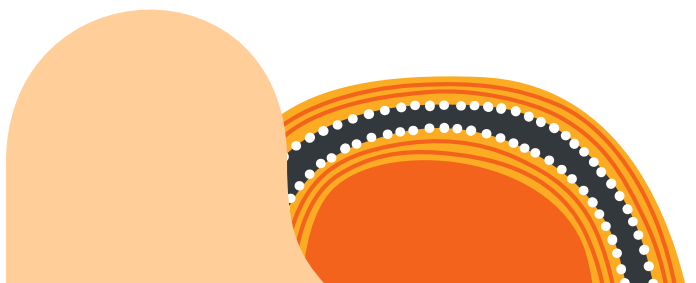

Executive summary

Document purpose

This consultation summary report provides the outcomes of engagement activities undertaken with stakeholders, the local community, and users of Berrys Bay for the draft Berrys Bay master plan.

The project

Between 30 September and 23 October 2022 Transport for NSW (Transport) sought feedback from the local community and the public about the draft master plan and vision developed for Berrys Bay. The vision outlines the evolution of a working waterfront into foreshore parklands and public spaces. It will complete the missing link in foreshore access on the Peninsula and reconnect the community and visitors to the Bay's histories, foreshore lands and water. The master plan sets out a visual representation for the area aligned to the vision statement including a high-level conceptual layout with proposed functional uses.

How we engaged

The opportunity to find out more about the project and to give feedback was provided through several channels, both in person and online. In-person meetings were held with key stakeholders including North Sydney Council, Ms. Felicity Wilson MP, Member for North Shore, the Berrys Bay Community Stakeholder Working Group and local precinct committees.

Broader public and community engagement occurred through targeted door knocks, a letterbox dropped community update, social media posts and an email to subscribers and posters in the local community. An interactive portal displaying the draft master plan and containing a survey was linked from all communication, as well as the Western Harbour Tunnel website.

Who we heard from

Over the course of the public consultation period, the team received 146 survey responses, 13 submissions and hosted 74 people at two community drop-in sessions.

The immediate suburbs surrounding Berrys Bay (Waverton, McMahons Point, Wollstonecraft) accounted for most survey responses, with 64% of respondents living in these suburbs.

What we heard

Survey responses provided strong support for the vision to transform Berrys Bay from a working waterfront into foreshore parklands and public spaces, with approximately 80% of respondents agreeing with the vision. This included 49% who responded, "strongly agree".

The survey results and submissions indicate the community would like to see the Bay made into an accessible public space that provides broader community benefit and recreation opportunities. The preferred features of the draft master plan from the survey respondents, in order of preference, were:

- picnic areas with seating, BBQs, and shade
- tidal steps to provide connection to water

- continuous and accessible foreshore path
- open space for informal recreation.

Respondents supported the inclusion of the following features to support the precincts:

- wet gardens to improve runoff water quality
- improved boat access
- improved access to water
- additional kayak/small boat storage.

The survey asked about the potential future uses for the existing buildings at Berrys Bay. The community was supportive of a café or restaurant in Woodley's Shed and a community centre in the Administration building. Some respondents also requested an early handover of buildings prior to construction commencing on Western Harbour Tunnel.

Written submissions were generally positive. Around half of the submissions supported the master plan but set out additional actions they believed could be completed. These include planting complementary native vegetation, providing adequate parking or taking action to immediately stabilise and protect Woodley's Shed.

Feedback received at the community information sessions included maintaining quiet uses at the Bay, discussion around preventing development at the Bay, such as housing that may attract larger boats or ferries and ensuring that new plantings are in keeping with the existing native bushland in the area. In contrast, there were contradictory views from all stakeholders about the provision of parking. Some expressed a need for more parking in the area, and some believed that the current parking facilities were sufficient. This feedback was also replicated across the surveys and written submissions.

Other comments received in the submissions related to transferring publicly owned land to North Sydney Council, early access to Woodley's Shed, protecting heritage, and need for additional kayak/boat storage.

Next steps

Transport will now consider community feedback received and the master plan may be further refined based on this feedback. The final Berrys Bay master plan will be released in early 2023.

About the project

Background

The Western Harbour Tunnel will provide a new motorway tunnel connection across Sydney Harbour between Rozelle and the Warringah Freeway near North Sydney.

The NSW Government has committed to enabling the delivery of a new foreshore park at Berrys Bay.

The Berrys Bay draft master plan, prepared by Transport, provides a visual representation for the area, and includes a high-level conceptual layout with proposed functional uses. This will be used along with the site analysis and design principles to guide the future detailed design of Berrys Bay.

Berrys Bay master plan consists of three distinct areas:

- Precinct 1 - Former BP Site
- Precinct 2 - Woodley's Boatyard
- Precinct 3 - Quarantine Boat Depot.

Berrys Bay vision

The vision for Berrys Bay master plan is the evolution of a working waterfront into foreshore parklands and public spaces. It will complete the missing link in foreshore access on the Peninsula and reconnect the community and visitors to the Bay's histories, foreshore lands, and waters.

Key features

The draft master plan includes key community benefits that meet the vision:

- enabling 1.9ha of public open space – equivalent to three football fields
- re-use of impacted heritage buildings and fabric to support future community and recreational uses
- a continuous and accessible foreshore path that provides the missing link on the Waverton peninsula
- improved access to the water with a new jetty, retention of the Woodley's Boatyard slipways and tidal steps to provide new water access from the BP site
- planting to extend the bushland.

Engagement activities

Community engagement on the draft master plan took place between Friday 30 September and midnight Sunday 23 October 2022.

Stakeholder briefings and meetings

Briefings and meetings were held with the following stakeholders.

Table 1 Stakeholder briefings and meetings

Date	Stakeholder
29 August 2022	Ms. Felicity Wilson MP, Member for North Shore
31 August 2022	North Sydney Council
5 September 2022	Berrys Bay Community Stakeholder Working Group
14 September 2022	Walk on Country
11 October 2022	Waverton Peninsula Working Group
17 October 2022	Berrys Bay Community Stakeholder Working Group
1 November 2022	Waverton Precinct Committee (noting meeting was rescheduled from October)

Media Release

A media release was issued for the project by Ms. Felicity Wilson MP, Member for North Shore, on 30 September 2022. A copy of the release can be found via Ms. Wilson's website:

<https://felicitywilson.com.au/media/draft-berrys-bay-master-plan-released-for-community-consultation>

Door knock

The project team doorknocked to encourage community attendance at the information sessions and alert the immediate community to the public display. The following areas were targeted:

- 2 – 22 Larkin Street, Waverton
- 3 – 25 Balls Head Road, Waverton

Several residents were home and wanted to hear more about the consultation. Many had already heard about the project and were interested in attending the community information sessions.

Community update and posters

The community update was distributed to approximately 6,500 residences and businesses at Blues Point, McMahons Point, North Sydney, Waverton and parts of Wollstonecraft on Sunday 2 October 2022.

Posters were installed around Berrys Bay, Waverton and key community locations with a QR code to the interactive portal and survey in the following locations:

- The Coal Loader Centre for Sustainability
- Carradah, Berrys Bay and Waverton Parks
- Wollstonecraft
- Waverton and North Sydney stations.

Copies of the community update were handed out at Waverton Station on Tuesday, 11 October 2022 between the hours of 6am-10am and 3pm-7pm.

A map of the distribution area and a copy of the community update and the poster are available in Appendix A - C.

Social media

Four advertisements were published on Facebook during the display period including geo-targeted posts and duplicate posts to the Greater Sydney region. The advertisements included a link to the interactive portal. Copies of the advertisements can be found in Appendix D.

Table 2 Geo-targeted Facebook posts

Targeted Suburbs: Waverton 2060, North Sydney 2060, McMahons Point 2060, Lavender Bay 2060, Wollstonecraft 2060					
Date	Reach	Link clicks	Reactions	Shares	Comments
30 September – 7 October	12,299	444	21	3	7
6 – 13 October	13,285	224	85	12	20
12-17 October	14,411	185	9	1	2
17 - 23 October	17,123	411	12	1	0

Table 3 Duplicate Facebook posts to Greater Sydney

Targeted Suburbs: Greater Sydney					
Date	Reach	Link clicks	Reactions	Shares	Comments
30 September – 7 October	11,204	312	15	3	3
6 – 13 October	3,461	45	6	0	1
12-17 October	10,218	152	4	0	2
17 - 23 October	10,455	464	8	2	2

Interactive portal and survey

An interactive portal was developed to overlay the draft master plan over the study area for people to examine the proposal in detail. The portal also contained a brief survey. A copy of the survey questions is available in Appendix E.

A total of 146 surveys were filled out, with additional comments being submitted via the "Contact us" form.

Table 4 Interactive portal visitor data

30 September – 23 October	Unique Visitors	Total Page views	Total Sessions	Average session length
Interactive portal	3,129	4,122	3,799	3:33 minutes

Community information sessions

Two community information sessions were held with a total of 74 visitors attending.

Table 5 Community information sessions

Date	Location	Attendees
Thursday 13 October, 4-7pm	Mess Hall, Coal Loader Centre for Sustainability	45
Monday 17 October, 11am – 2pm	Mess Hall, Coal Loader Centre for Sustainability	29

Email

An email was sent out on Friday 30 September 2022 to 3,271 recipients. The purpose of the email was to distribute the community update, provide the dates of the community drop-in sessions and link to the interactive portal and survey. The recipients were those that have subscribed to the Western Harbour Tunnel subscriber list of people who have elected to receive emails about the project and associated works.

A reminder email containing the same information went out on Thursday 20 October 2022 to 3,256 recipients.

A copy of the emails is contained in Appendix F.

Engagement outcomes

The key feedback received from the survey responses and the submissions are outlined below.

Survey Results

The survey was divided into three main sections:

- the vision and suggested programming and features for the site
- questions about re-use of buildings including Woodley's Shed and the Administration Building
- an open question seeking further comments or suggestions.

Demographics of survey respondents

The survey collected demographic data of respondents; however, email submissions did not provide this information.

Of the 146 survey respondents, the majority, 93 people, lived in the areas immediately surrounding Berrys Bay. These suburbs include Waverton, McMahons Point and Wollstonecraft. A further 20 respondents reside in neighbouring suburbs, including North Sydney, Crows Nest, Lane Cove and Northwood.

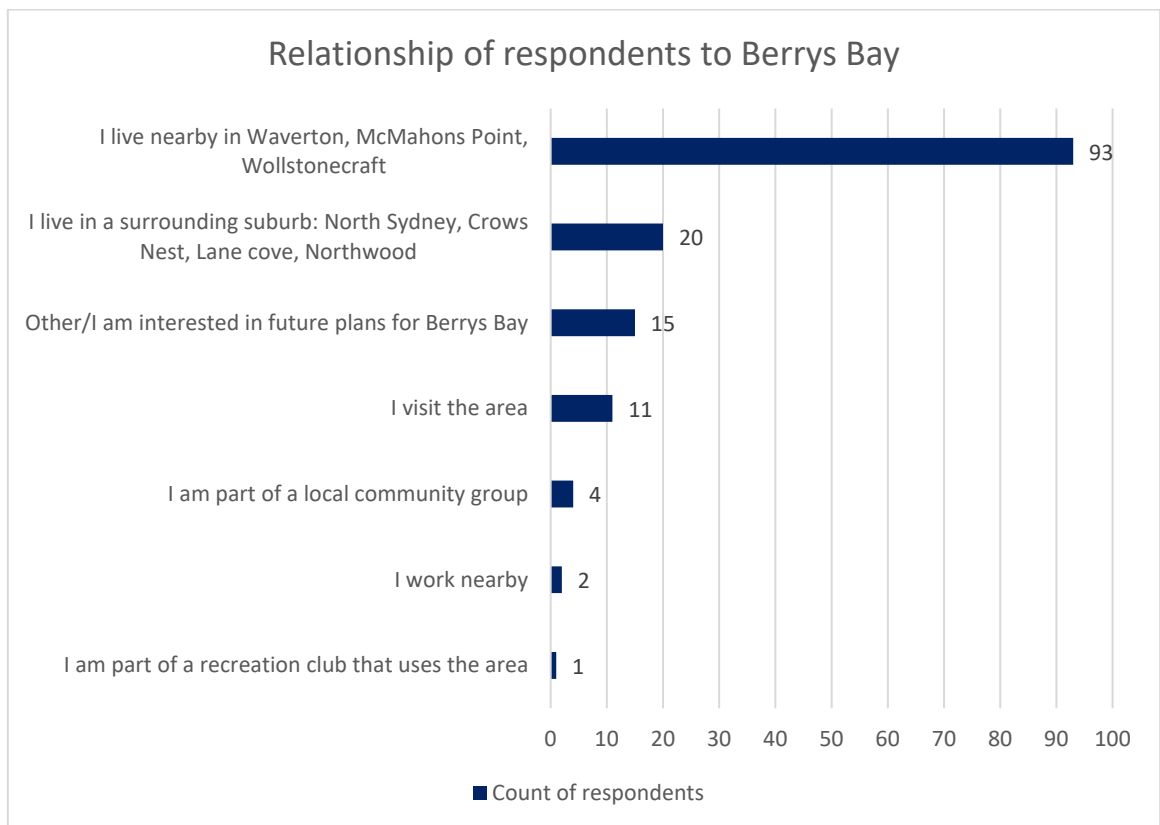

Figure 1 Relationship of respondents to Berrys Bay

The majority of respondents (79%) were over 45 years of age. Comparing the age of the respondents against the most recent census data (2021) in the suburbs of Waverton, McMahons Point, and Wollstonecraft (the areas immediately neighbouring Berrys Bay) shows that younger age groups are not well-represented in the survey respondents. The census data shows that 52% of the population are under 45; however, only 21% of survey respondents are under 45.

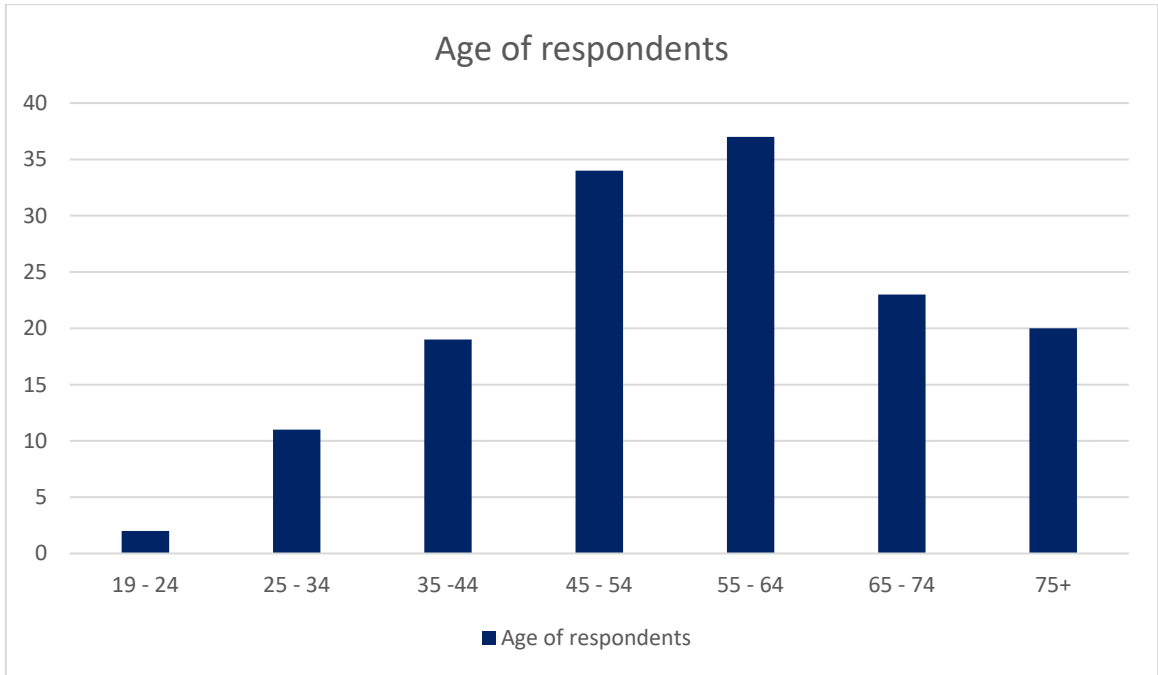

Figure 2 Age of respondents

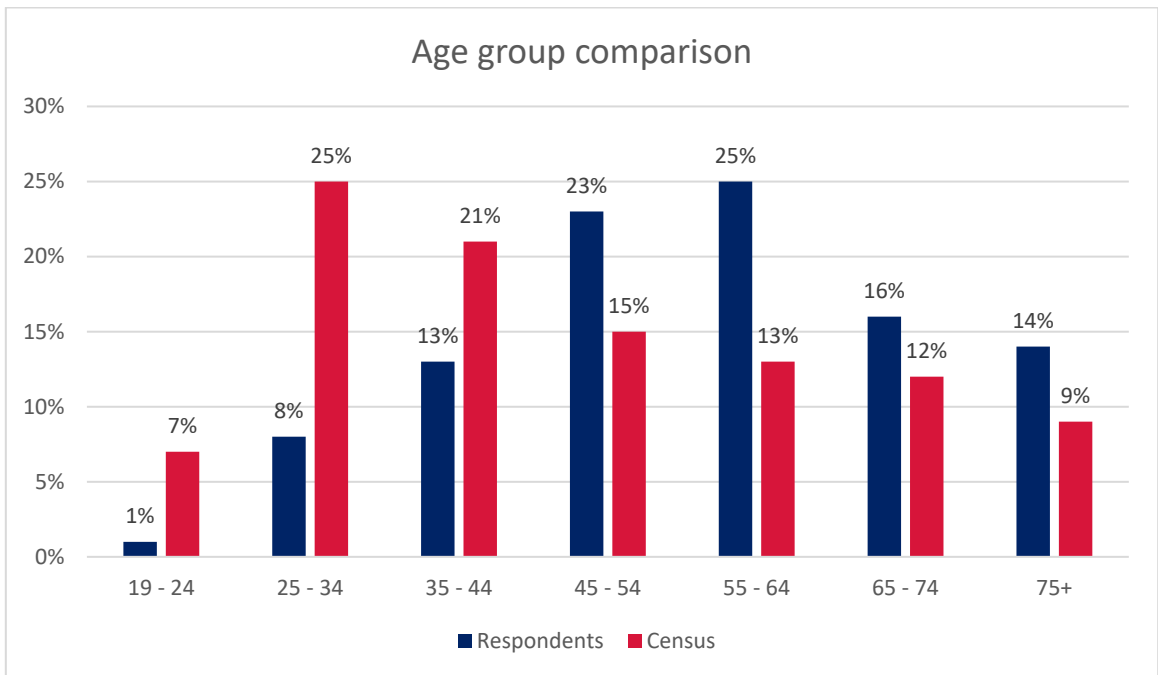

Figure 3 Age group comparison between respondents and residents of neighbouring suburbs from 2021 census data

Vision and proposed programming

The proposed vision for the site garnered almost 80% support from respondents. The vision on the portal for Berrys Bay was:

The evolution of a working waterfront into foreshore parklands and public spaces. It will complete the missing link in foreshore access on the Peninsula and reconnect the community and visitors to the Bay's histories, foreshore lands, and waters.

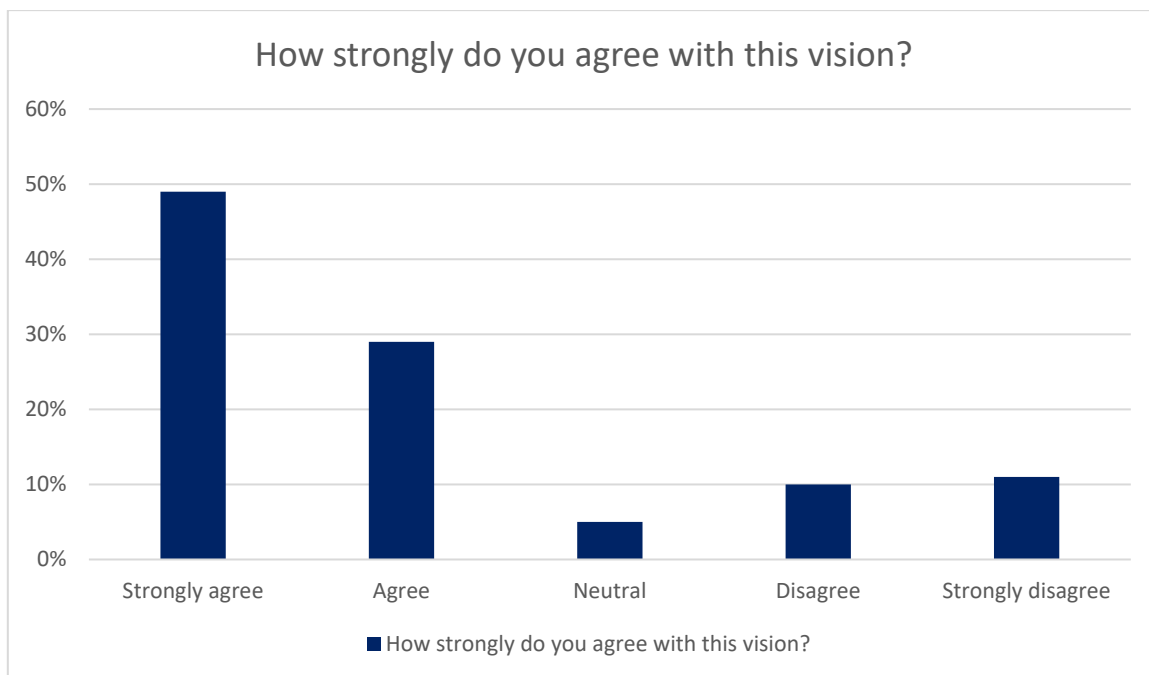

Figure 4 How strongly do you agree with this vision?

The overarching sentiment that emerged from the comments was support for creating new accessible public open space for community benefit and additional recreation (63%, 91 people). Other respondents mentioned the retention of heritage features in the area (9 people), while others thought the plan did not adequately consider maritime uses (9 people).

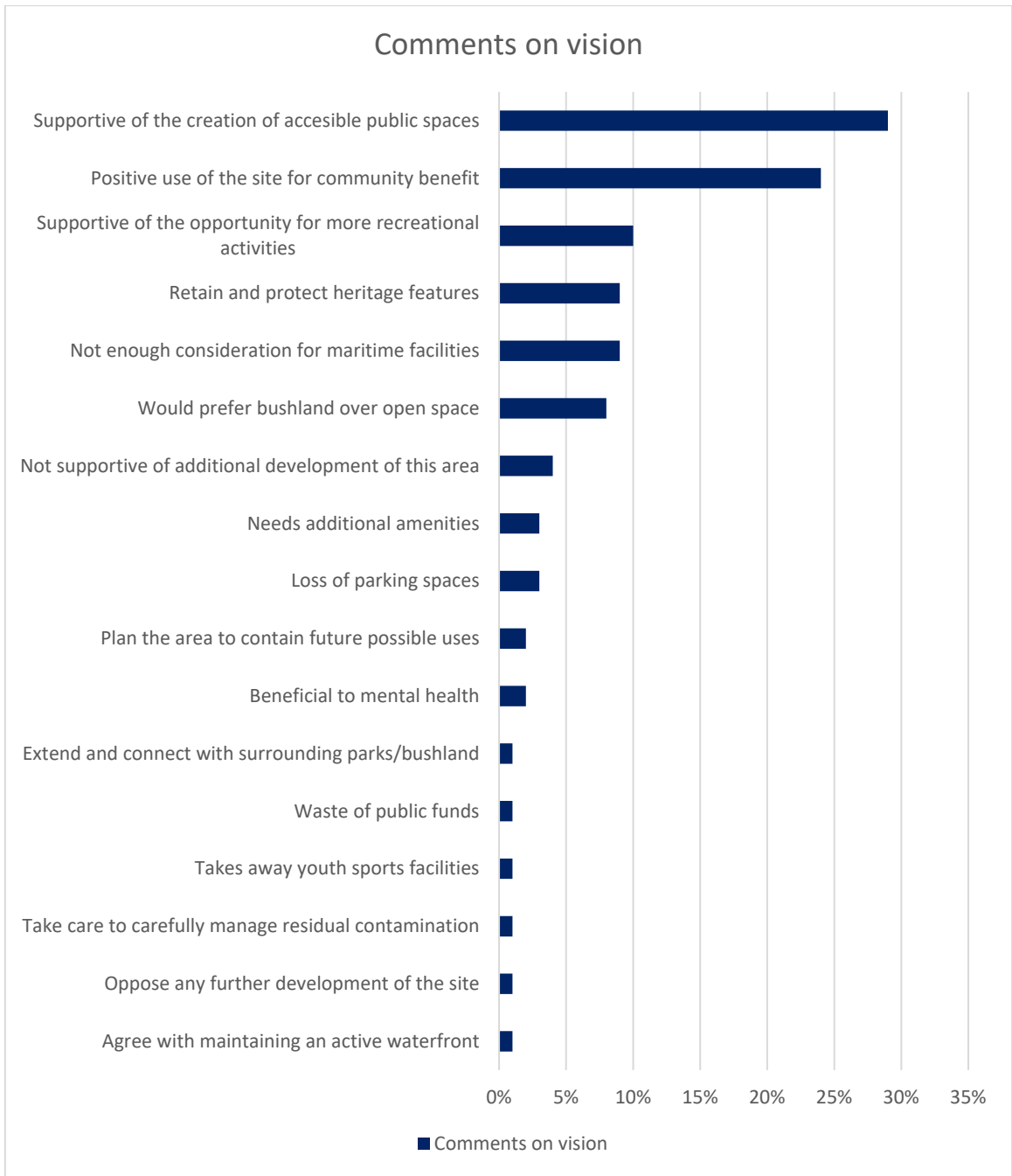

Figure 5 Comments on vision

Use of space features

On the website, specific use of space features were illustrated and noted with hotspots. The survey then asked respondents to “drag and drop” their 15 preferred features in order of importance to them.

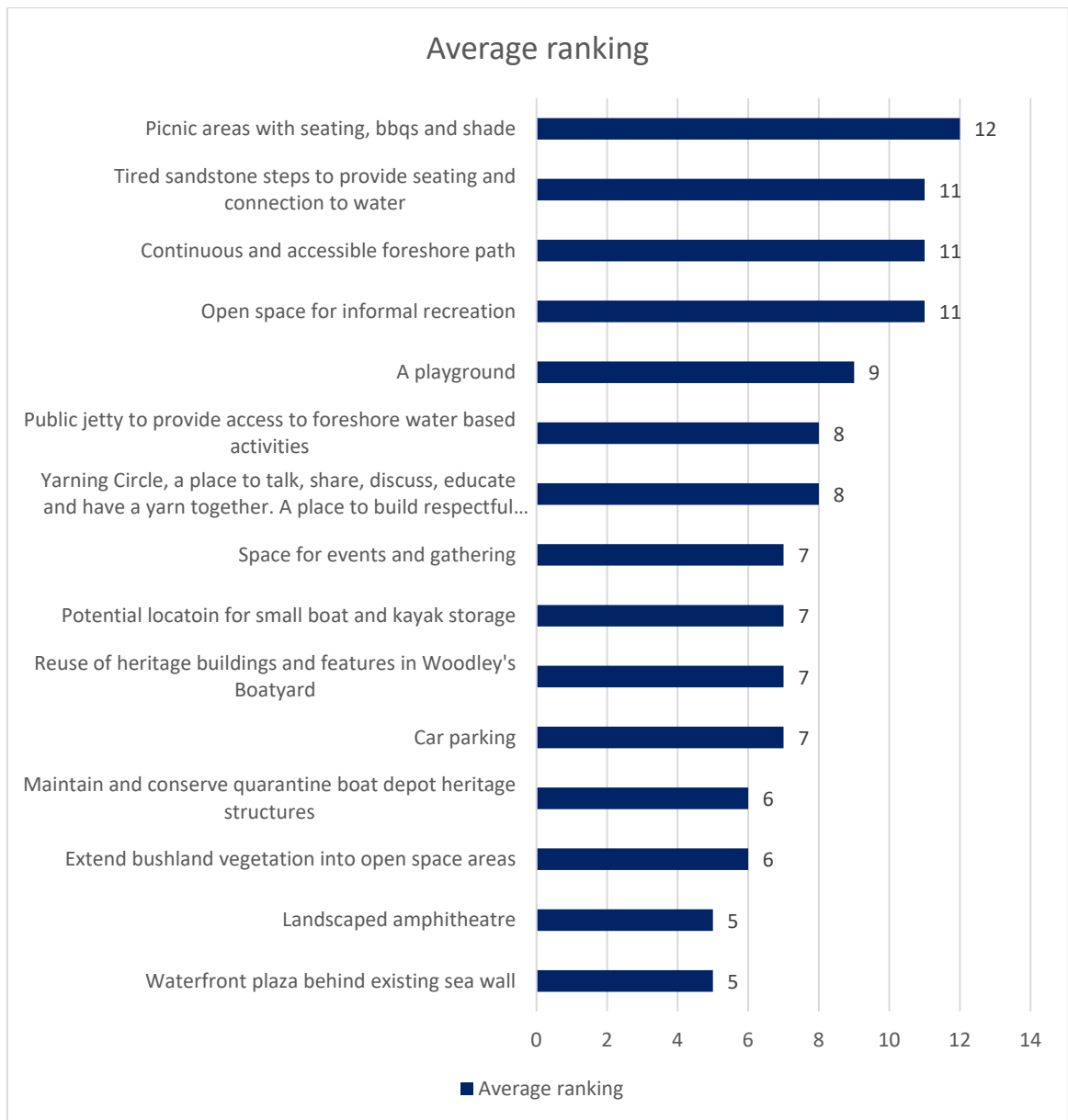

Figure 6 Use of space features ranked

Based on the preferences of respondents for space features, the community supports inclusion to the master plan of seating and BBQ facilities with added shade, tidal steps to the water; a continuous and accessible foreshore path and open space for informal recreation. Supporting these use of space features, respondents were asked about their preferred specific design features that could be used to support the master plan. Respondents were not asked to rank these design features but could select as many or as few as they liked. Wet gardens to improve water quality in the bay were overwhelmingly supported, along with retaining and celebrating the site’s industrial heritage. Indigenous heritage in the physical environment, was also a highly ranked feature the community would like to see in the precincts.

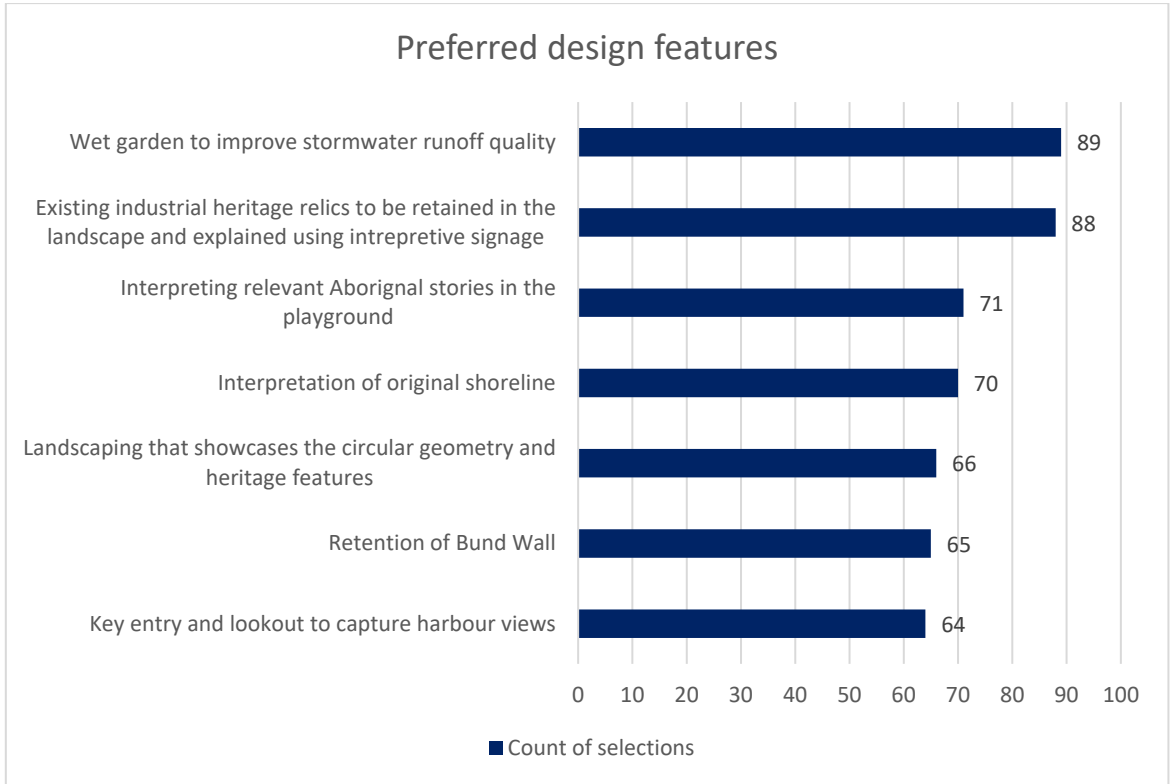

Figure 7 Preferred design features

Playground

The survey asked respondents their thoughts about a playground at the Bay, and the type and age group that it should cater to. The master plan proposes an adventure playground designed to cater for all ages and abilities with an emphasis on youth recreational needs.

70% of respondents (88 people) agreed with this statement, indicating firm support for a playground. However, the comments showed that 30% (19 people) of respondents believe that no playground is needed in this area. A further 21% (13 people) agreed that a playground should cater for all ages. Of the 63 respondents that made comments, five people mentioned car parking. Some mentioned the area should be used as a car park instead of a playground and others mentioned that adequate car parking should be provided.

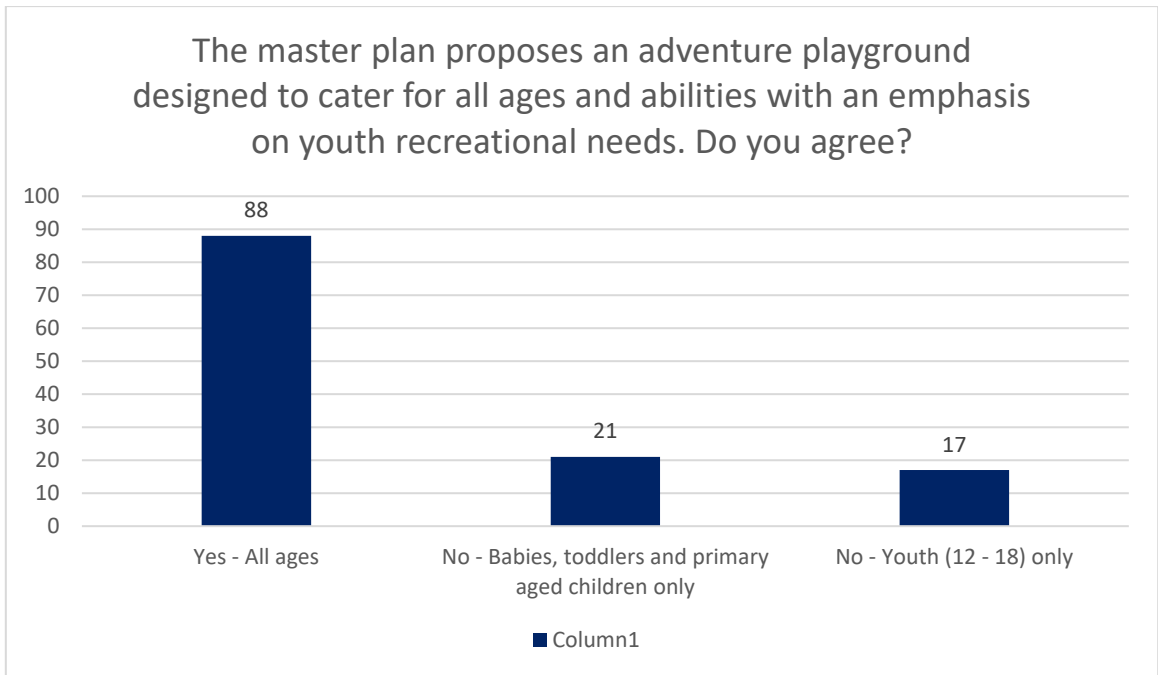

Figure 8 The master plan proposes an adventure playground designed to cater for all ages and abilities with an emphasis on youth recreational needs. Do you agree?

Woodley's Shed and the Administration Building

We asked the public what uses they would like to see within Woodley's Shed and the Administration Building. The clear response focused on a hospitality offering (café/kiosk/restaurant) and community/creative space. There is also a small group of respondents (10 comments) who would like to see it restored to a working boatyard. As the question allowed open text responses, we have grouped these in the figure below.

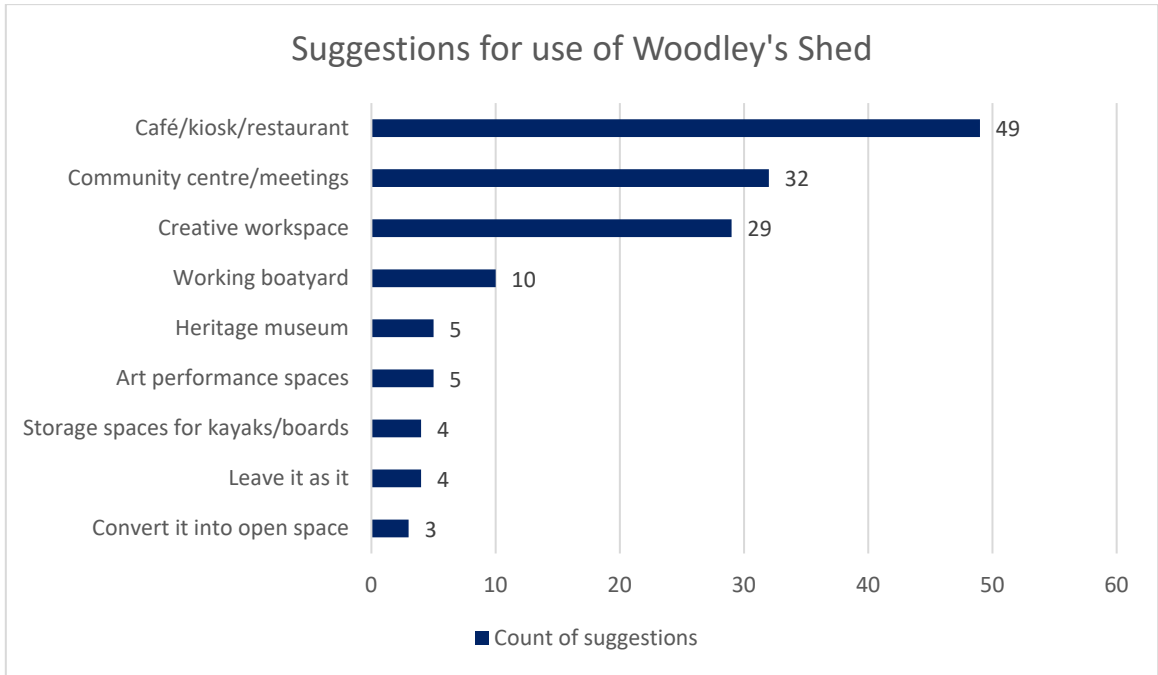

Figure 9 Tell us how you would like to see Woodley's Shed in the Boatyard used in the future

The Administration Building also received similar responses with the top uses reversed the preference being for a community centre/meeting space. The differences in response could be due to the location of the buildings, with the administration building being closer to Balls Head Road. Eight comments were received about turning the building into a heritage museum and seven comments were recorded suggesting that this building be demolished.

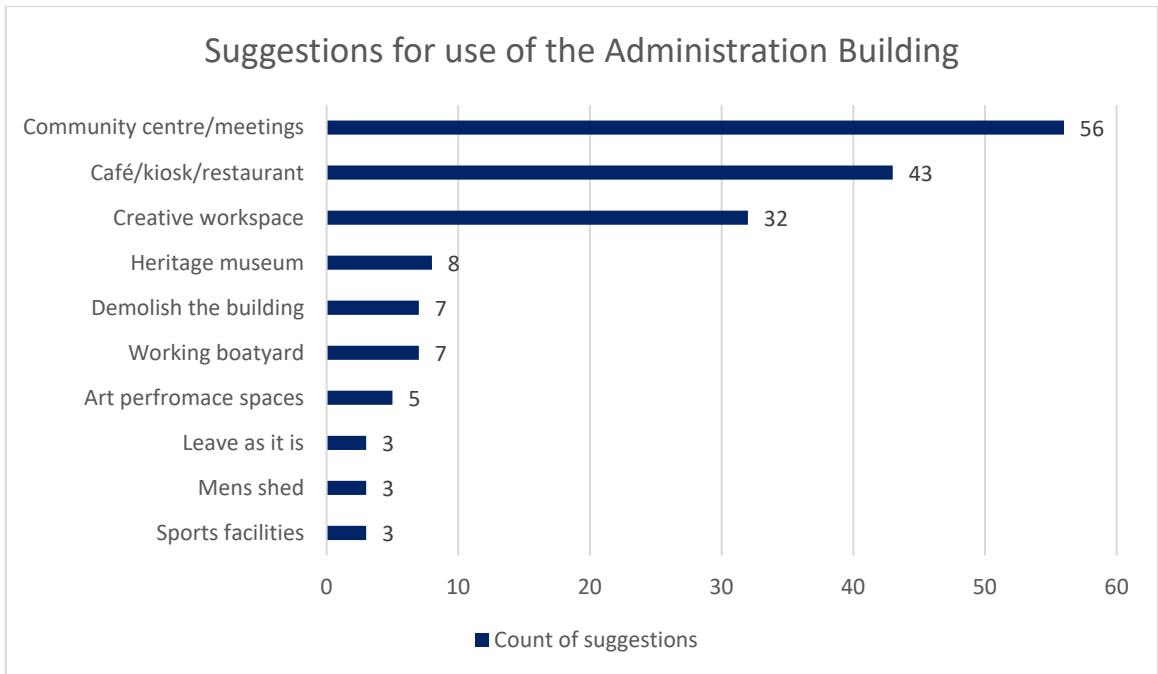

Figure 10 Tell us how you would like to see the Administration Building in the Boatyard used in the future?

Features and improvements

The last question sought suggestions and ideas from the community about features and ideas not already mentioned in the survey. This was an open text question, with 119 responses received. Final suggestions

were grouped loosely to acknowledge as many as possible. However, there were some key features that stood out in the responses, namely, kayak and small boat storage and parking.

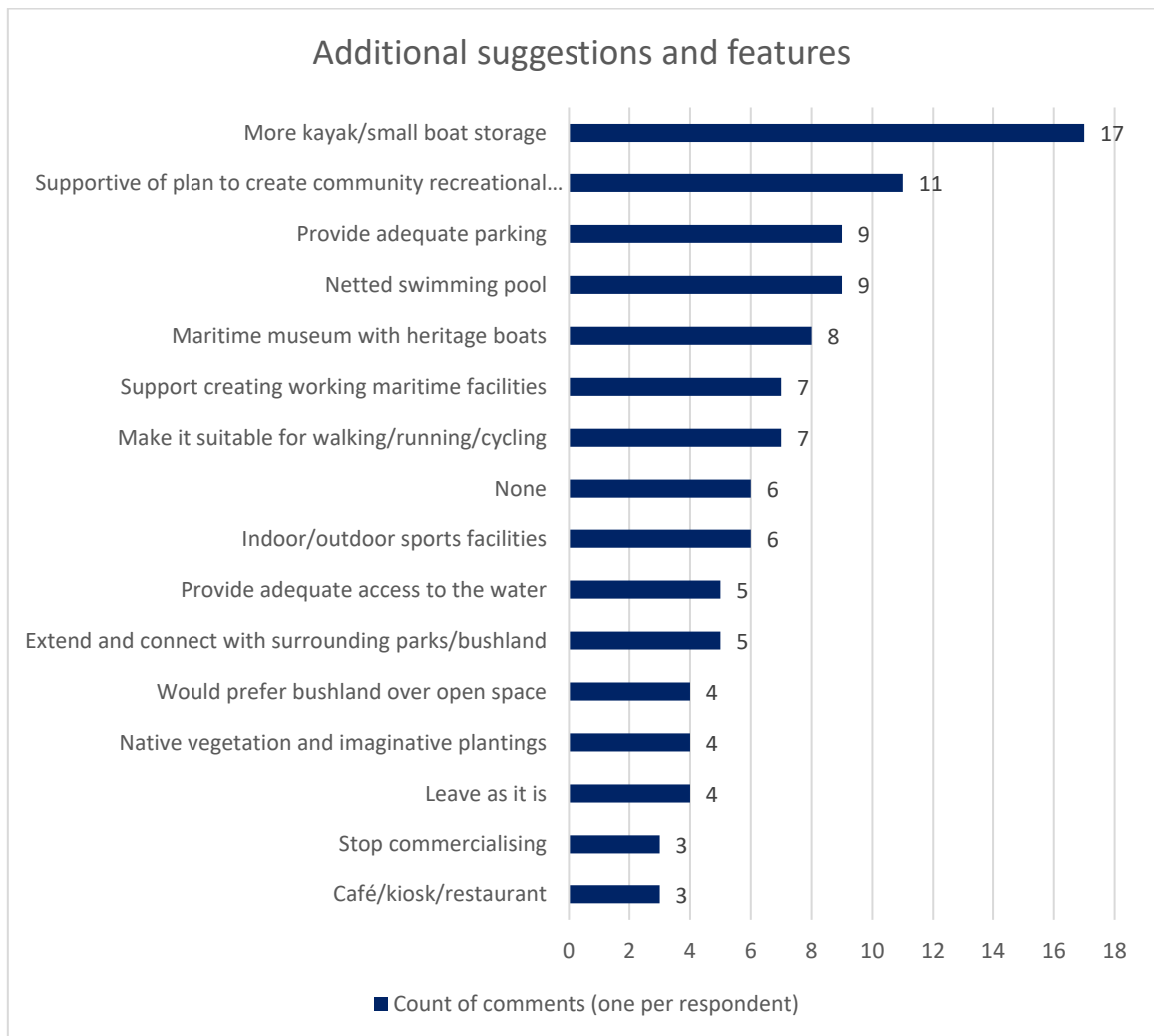

Figure 11 Suggested features and improvements

Submissions

A total of 13 written submissions were received via email during the public display.

Two submissions came from local community groups: the North Shore Historical Society and the Edward and Union Precincts in North Sydney Council area. A detailed submission was provided by the Sydney Heritage Fleet and the balance of the submissions were from individuals.

Sydney Heritage Fleet’s submission was a proposal to relocate the fleet’s collection to Berrys Bay to create ‘The Museum of Sydney Harbour’ as a cultural historic attraction. The proposal involves; relocating front and back of house operations to Berrys Bay, a new museum building, small community marina (maximum 26 berths), heritage vessel berths, additional wharves along BP site to accommodate tour boats and potential public ferry, café, car parking, secure undercover storage for canoe/kayaks/dinghy with change facilities for fee, launching ramp, and continuous foreshore walkway.

Most written submissions raised more than one issue; therefore, a count of issues was carried out to capture the breadth of those raised.

The top three issues raised in the submissions centered around the restoration of Woodley’s Shed, the need for adequate parking and community opposition to development in the area. Each of these issues was

mentioned seven times across the 13 submissions. Four submissions commented about turning Woodley’s Shed into a maritime museum.

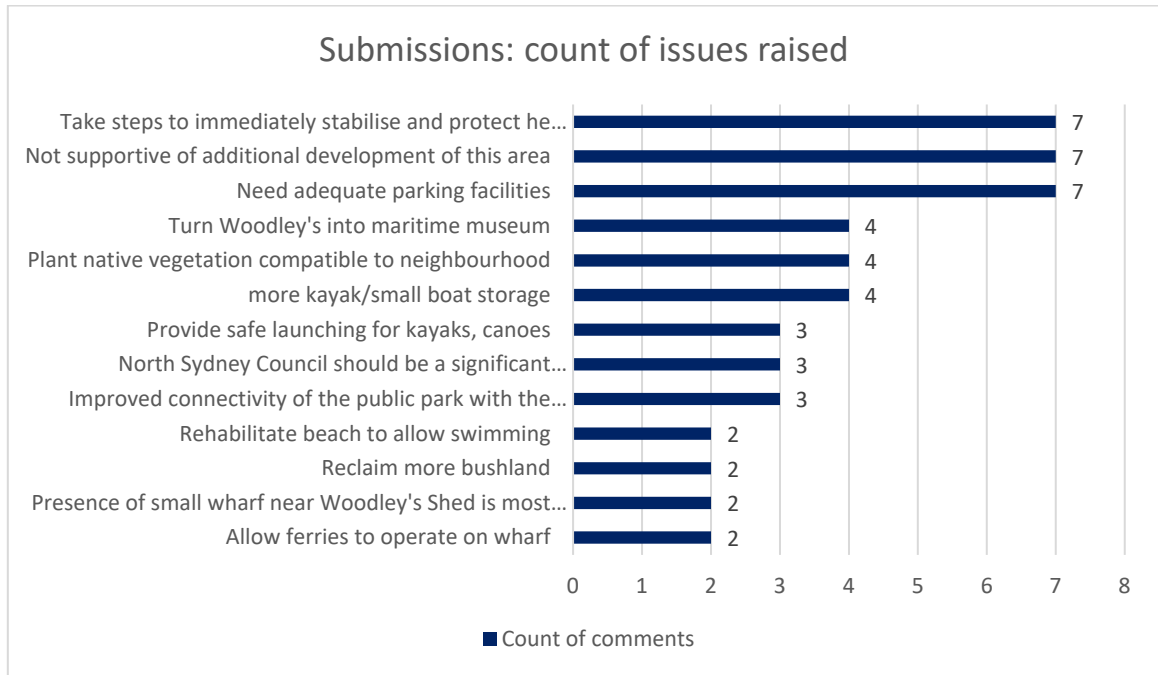

Figure 12 Submissions: count of issues raised

Community information sessions

Two community information sessions were held on 13 October 2022 and 17 October 2022 at the Coal Loader Centre for Sustainability. The sessions provided an opportunity for the community to enquire about the Berrys Bay Master plan and ask general questions in relation to Western Harbour Tunnel construction and timing.

The first session was well attended with 45 individuals; including representatives from the Sydney Heritage Fleet. The second session had 29 attendees, including representatives from the Waverton Precinct Committee.

Most attendees supported the current draft master plan, and many shared their ideas regarding future use of Woodley’s Shed and the Administration Building. There was also appreciation of the attempts to keep the space as natural as possible without over development. As noted previously, there were contradictory views about parking in the area, with some suggesting that additional parking be placed behind the Bund Wall. Other topics that were mentioned include a lack of consideration regarding the access to water and the removal of the deteriorating jetties.

There were many questions regarding timing around delivery and commencement of Western Harbour Tunnel construction, as many attendees reside within a one kilometre radius of the site.

Community and Stakeholder Working Group (CSWG)

The CSWG was held on 17 October 2022 and well attended with six community representatives and two representatives from North Sydney Council.

The CSWG was provided with an overview of the community engagement since the release of the Berrys Bay draft master plan and feedback that the community had received the plan positively.

The CSWG then reviewed the vision and stepped through each precinct and the various programming and design elements. The CSWG have provided their final recommendations on the Berrys Bay draft master plan and it is available via the online portal at nswroads.work/whtportal.

The CSWG will reconvene once the Berrys Bay master plan has been finalised and approved.

Key themes

Open space

Overwhelmingly, survey respondents were supportive that the site provides open space for active or passive recreation, with 63% indicating this was the key aspect of the vision they agreed with. There was also strong community support for features that enable the provision of open space, such as seating and BBQ facilities with added shade, tiered steps to the water, a continuous and accessible foreshore path and open space for informal recreation.

Playground

The draft master plan proposed an all-ages adventure playground behind the Bund Wall in response to community engagement early in the master plan process and recreational needs analysis.

Responses to the proposal of an adventure playground for the area were mixed. 88 respondents supported the proposal for an all-ages adventure playground, while another 31 respondents wanted playgrounds that either cater to babies and toddlers or older children (12-18 years). In addition, 19 respondents noted that the area does not require a playground.

Car parking

Survey comments and discussions with the community indicate that the topic of car parking has conflicting viewpoints. The master plan strives to improve public access to Berrys Bay while maximising open space for a range of recreational activities and uses. 16 additional car spaces, including four accessible parking spaces, are proposed in the draft master plan. The majority of responses support this but there are respondents that want car parking to be provided within the site, for example behind the Bund Wall instead of a playground. Others worry that any additional parking may attract more visitors to the site in excess of its capacity. There were also comments around consideration of parking needing to be undertaken within the context of the future use of Woodley's Shed and the Administration Building.

Heritage

Heritage is a theme that was interwoven throughout the responses received, and across different types of heritage. These types included celebrating the Indigenous heritage of the site through landscape design and the playground, recognition of the site's maritime history and highlighting the remnants of the former BP site.

Future use of existing buildings

We recognise the opportunity that re-use of existing buildings at Berrys Bay provides for activating the precincts and providing community use. This has also been reflected in the feedback we have received which has shown that the conservation and protection of heritage items is important to the community.

Mixed views were received from respondents about the future uses for Woodley's Shed and the Administration building. Ten comments were received suggesting that Woodley's Shed be restored back to a working boat yard. Some people want the buildings demolished (7 comments), while others want the buildings repurposed into a museum (5 comments).

Other respondents also referenced the Sydney Heritage Fleet proposal directly or the potential opportunity for the Sydney Heritage Fleet to use Woodley's Shed and/or moor some of their fleet in the Bay.

Water access

People were supportive of a greater connection to the water through the inclusion of a jetty, slipways, foreshore seating and tidal steps. Attendees at the community information sessions noted that this access is not possible in other areas of the peninsula and is therefore valued highly at this location.

Kayak and small boat storage

The need for kayak and small boat storage was expressed strongly in the survey and submissions. The use of space ranking in the survey included kayak and small boat storage in the top ten uses. Regarding suggestions for the re-use of Woodley's Shed, four suggestions were made for using the site for kayak/small boat storage. The end of the survey provided for respondents to add further comments and suggestions. In this section, making a place at Berrys Bay for kayak and small boat storage recorded 17 supportive comments ranking at the top of the topics listed by respondents.

Limiting development

One of the prominent issues to emerge from the consultation was that of limiting development in the area. This came through in the submissions and at the community information sessions. There were seven comments received through submissions that noted the community was not supportive of development at Berrys Bay. This was further echoed in comments received in the survey with six respondents noting they were not supportive of additional development of this area, one opposing any further development of the site and three comments regarding preventing commercialisation at/of the site.

During the community information session some attendees noted they did not want development at Berrys Bay. This was particularly so given the site adjoins Balls Head Reserve, with attendees preferring uses sympathetic to the bushland nature of the area.

Next steps

Transport will now consider community feedback received and the master plan may be further refined based on this feedback. The final Berrys Bay master plan will be released in early 2023. The master plan will be used along with site analysis and design principles to guide the future detailed design of Berrys Bay.

Appendix A - Community update

Berrys Bay Draft Master Plan

Western Harbour Tunnel

Community Update

September 2022

The vision for Berrys Bay master plan is the evolution of a working waterfront into foreshore parklands and public spaces. It will complete the missing link in foreshore access on the Peninsula and reconnect the community and visitors to the Bay's histories, foreshore lands, and waters.

Transport for NSW (Transport) has prepared a draft landscape master plan for Berrys Bay and we are seeking your feedback.

The Berrys Bay master plan will provide a vision to transform the former industrial land of Berrys Bay into usable public open space and the community have an exciting opportunity to shape the future of the site.

Transport engaged CONTEXT Landscape Architecture Pty Ltd to prepare a landscape master plan for Berrys Bay. The Berrys Bay draft master plan provides a visual representation for the area, and includes a high-level conceptual layout with proposed functional uses. This will be used along with the site analysis and design principles to guide the detailed design of Berrys Bay.



Artist's impression of Balls Head Road - Berrys Bay key focal area

Artist's impression of the former BP site, looking west along the foreshore path towards the bund wall.



What's happening?

The Western Harbour Tunnel will provide a new motorway tunnel connection across Sydney Harbour between Rozelle and the Warringah Freeway near North Sydney.

Government owned land at Berrys Bay is proposed for use during Western Harbour Tunnel construction.

The NSW Government has committed to enabling the delivery of a new foreshore park at Berrys Bay.

What's been done so far

Transport has worked closely with community and stakeholder groups throughout the development of the draft master plan. Engagement to date has included:

- Workshops with the Community and Stakeholder Working Group (CSWG). The CSWG includes local community representatives who have provided important perspectives and insights to help shape vision of the draft master plan
- Conversations with local Aboriginal knowledge holders to understand stories of Country and gain invaluable insights into cultural considerations
- Waverton Peninsula Community Values Survey
- Engagement with North Sydney Council

A diverse range of feedback has been provided by the CSWG. This consultation has ensured the development of a cohesive draft master plan which will respond to the needs of the community and complete the vision for the Waverton Peninsula.

What happens next?

The draft master plan is now open for community feedback and will remain open until **Sunday, 23 October**. We will review and consider community feedback received, including how you would like to see the Administration building and Woodley's Shed in the Boatyard used in the future, and the master plan may be further refined based on this feedback.

We are currently in the procurement phase for Stage 2 of the Western Harbour Tunnel. Transport will seek to identify opportunities for early staging and to facilitate early access to the Council beach.

Key components of the plan that meet the vision:



Enabling 1.9ha of public open space – equivalent to three football fields



Re-use of impacted heritage buildings and fabric to support future community and recreational uses



A continuous and accessible foreshore path that provides the missing link on the Waverton peninsula



Improved access to the water with a new jetty, retention of the Woodley's Boatyard slipways and new sandstone stairs to provide new water access from the BP site



Planting to extend the bushland

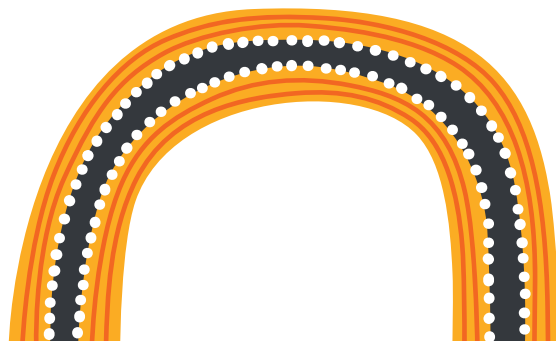

The next stage of master plan development is detailed design.

Elements that fall outside the NSW Government land, namely the Quarantine Boat Depot site (Precinct 3), along with feedback on future building uses will be provided to North Sydney Council for their consideration.

Transport is committed to the master plan vision which will be further developed collaboratively with the community.

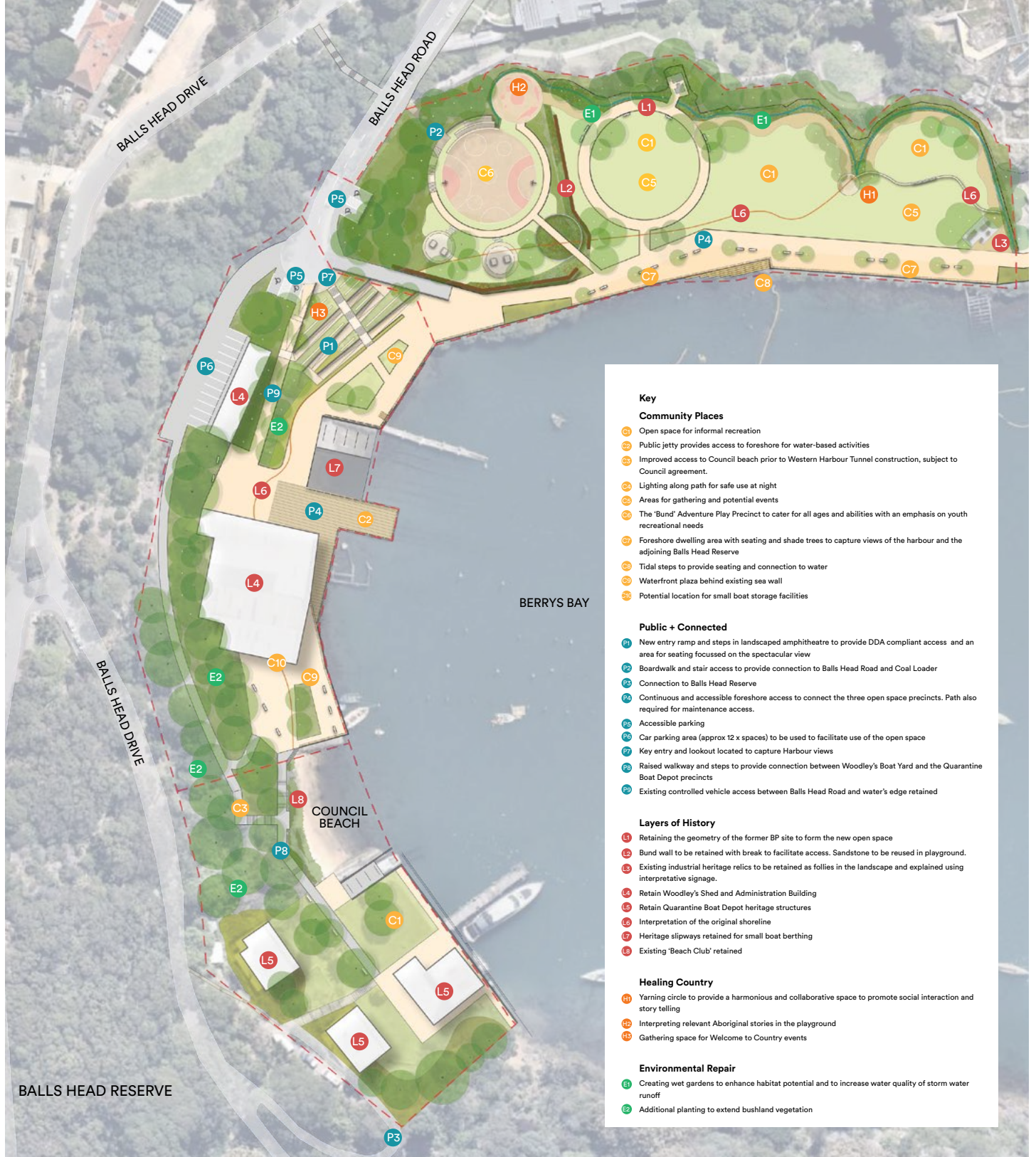

Berrys Bay draft master plan, CONTEXT September 2022

Master plan

The master plan provides a vision for completing the foreshore access along the Peninsula. It will reconnect the community and visitors to the Bay's stories, foreshore lands, and waters. The new open space at Berrys Bay seeks to complement the adjoining public spaces and emphasise community access to the Harbour's foreshore. The master plan provides a framework for the adaptive re-use of heritage buildings that will create a truly unique and community-oriented waterfront precinct.

The extent of the draft master plan is illustrated within the Site Overview Plan.

Berrys Bay consists of three distinct areas:

- **Precinct 1** – Former BP Site
- **Precinct 2** – Woodley's Boatyard
- **Precinct 3** – Quarantine Boat Depot

Visit the interactive portal to discover more about each precinct, view additional images and provide feedback.

Have your say

We invite the community to provide feedback on the draft master plan by providing feedback from now until **Sunday, 23 October**.

The complete Berrys Bay draft master plan and the Connection to Country Principles documents are available to download on the project portal.

The interactive portal features the master plan design which we are welcoming feedback on. We also invite you undertake a survey on the vision presented in the master plan. Feedback from the community will help us further refine the master plan.

To visit the online portal and provide feedback, please use the QR code or visit: nswroads.work/bbportal



Coal Loader Wharf

Community consultation on a vision for the future use of the nearby Coal Loader Wharf will commence in **late 2022**. For further updates and to be kept informed please visit www.transport.nsw.gov.au/coalloaderwharf

Information session

If you would like to have your say in person, two community information sessions will be held. These sessions will provide further detail regarding the draft master plan, and members of the project team will be available to answer any questions from the community. Information at these sessions will be the same.

Session 1

Time 4–7pm
Date Thursday,
13 October 2022

Session 2

Time 11am–2pm
Date Monday,
17 October 2022

Location Mess Hall
The Coal Loader Centre for Sustainability
Address 2 Balls Head Drive,
Waverton NSW 2060

Find out more

If you would like to find out more about the development of the master plan or the Western Harbour Tunnel project, please visit the Western Harbour Tunnel project page. This is where you can find out more information through informative videos and FAQs, submit a question, or subscribe to various distribution lists via the Contact Us tab at nswroads.work/whtportal

Contact us

If you would like to speak to us about our work, please call us on **1800 931 189**. You can also email us with your questions via berrysbay@transport.nsw.gov.au



Translating and interpreting service

If you need help understanding this information, please contact the Translating and Interpreting Service on **131 450** and ask them to call us on **1800 931 189**



PRIVACY STATEMENT: Privacy Transport for NSW ("we") are collecting your personal information in connection with the Western Harbour Tunnel and Beaches Link ("the Program"). In addition to collecting your name and contact details we may collect other information such as your submissions and other communications with us. We will retain and use this information for consultation purposes, including communications and analysis in connection with the Program. We will not disclose your personal information to third parties unless authorised by law and if we include your submissions in any public report we will not identify you. Providing your personal information is voluntary but if you do not provide it we may not include you on our stakeholder database and you might miss further consultation opportunities. Your personal information will be held by us and you can contact us to access or correct it. Please email us at whtbl@transport.nsw.gov.au, write to us at Transport for NSW, Locked Bag 928, North Sydney NSW 2059 or call us on 1800 931 189.

Appendix B - Community poster

Berrys Bay Draft Master Plan Western Harbour Tunnel



Have your say on the Berrys Bay draft master plan by Sunday, 23 October



Artist's impression of Balls Head Road

Transport for NSW (Transport) has prepared a draft landscape master plan for Berrys Bay and we are seeking your feedback.

The Berrys Bay master plan will provide a vision to transform the former industrial land of Berrys Bay into usable public open space.

Transport invites the community to have their say on the draft master plan by providing feedback from now until **Sunday, 23 October**.

We also invite you undertake a survey on the vision presented in the master plan. Feedback from the community will help us further refine the master plan.

If you would like to have your say in person a community information session will be held at The Coal Loader Centre for Sustainability on **Thursday, 13 October**.

Session time	4-7pm
Date	Thursday, 13 October 2022
Location	Mess Hall, The Coal Loader Centre for Sustainability
Address	2 Balls Head Drive, Waverton NSW 2060



Visit the interactive portal to learn more and complete the survey

To visit the online portal and provide feedback, please use the QR code or visit nswroads.work/bbportal

Please complete the survey by **Sunday, 23 October 2022** to have your say.

Contact Us

If you have any questions relating to this survey or generally regarding the Waverton Peninsula, please contact our team at:

berrysbay@transport.nsw.gov.au

1800 931 189



Translating and interpreting service

If you need help understanding this information, please contact the Translating and Interpreting Service on 131 450 and ask them to call us on 1800 312 772.

Appendix C – Community update distribution map

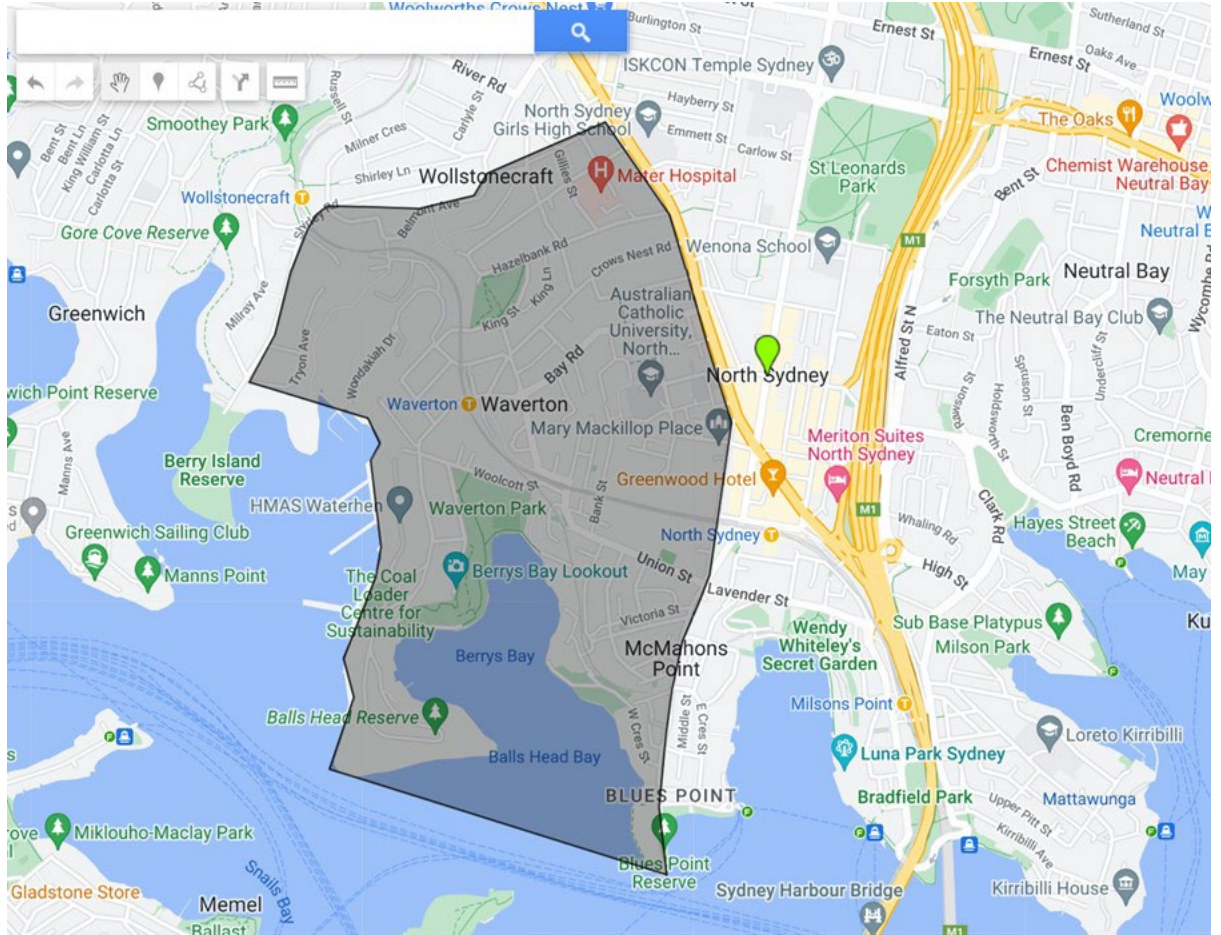

Appendix D – Social media posts

NSW Transport for NSW  Sponsored   

 We're unveiling plans for the Waverton Peninsula! Have your say on the Berrys Bay draft master plan before Sunday 23 October. 



nswroads.work/bbportal
Berrys Bay draft master plan 

NSW Transport for NSW  Sponsored   

 Drop in to our community info session at 4pm, Thurs 13 Oct to check out our proposed Berrys Bay draft master plan and have your say.



nswroads.work/bbportal
Berrys Bay Community Info Session 

NSW Transport for NSW  Sponsored   

 Drop in to our community info session at 11am, Mon 17 Oct to check out our proposed Berrys Bay draft master plan and have your say.



nswroads.work/bbportal
Berrys Bay Community Info Session 

NSW Transport for NSW  Sponsored   

 Last chance! Have your say on the Berrys Bay draft master plan by Sunday 23 October. Click learn more to take the survey today. 



nswroads.work/bbportal
Berrys Bay draft master plan 

Appendix E – Survey questions

Question 1. Transport for NSW has developed a vision for Berrys Bay to guide transformation of the former industrial land into usable public open space.

A Peninsula of Parklands

The evolution of a working waterfront into foreshore parklands and public spaces. It will

complete the missing link in foreshore access on the Peninsula and reconnect the community and visitors to the Bay's histories, foreshore lands, and waters.

How strongly do you agree with this vision?

1. Strongly agree
2. Agree
3. Neutral
4. Disagree
5. Strongly disagree

Question 1a. Please tell us why you agree or disagree with the vision.

Question 2. Please **rank** your preferred use of space that you would most like to see featured [rank 15 in order of importance]

- Picnic areas with seating, bbqs and shade
- Tiered sandstone steps to provide seating and connection to water - C8
- Open space for informal recreation - C1
- A playground - C6
- Yarning Circle- a place to talk, share, discuss, educate and have a yarn together, a place to build respectful relationships - H1
- Car parking – P5 and P6
- Space for events and gathering - C5
- Continuous and accessible foreshore path - P4
- Public jetty to provide access to foreshore for water-based activities - C2
- Potential location for small boat and kayak storage - C10
- Landscaped amphitheatre - P1
- Waterfront plaza behind existing sea wall – C9
- Re-use of heritage buildings and features in Woodley's Boatyard - L4
- Maintain and conserve Quarantine boat depot heritage structures - L5
- Extend bushland vegetation into open space areas – E2

Question 3. What design features would you like to see to support these uses?

[rank in order of importance]

- Wet gardens to improve stormwater runoff quality - E1
- Retention of Bund Wall - L2
- Interpretation of the original shoreline - L6
- Landscaping that showcases the circular geometry and heritage features - L1
- Key entry and lookout located to capture harbour views - P7
- Existing industrial heritage relics to be retained in the landscape and explained using interpretative signage - L3
- Interpreting relevant Aboriginal stories in the playground - H2

Question 4. The master plan proposes an adventure playground designed to cater for all ages and abilities with an emphasis on youth recreational needs (C6). Do you agree?

- Yes - All ages
- No - Babies, toddlers and primary aged children only
- No - Youth (12-18) only

Question 4a. Do you have any additional comments on the design of the playground

Question 5. Tell us how you would like to see Woodley's Shed (L4) in the Boatyard used in the future. For example, community meeting/function space, creative workspace, Café/kiosk

Question 6. Tell us how you would like to see the Administration Building (L4) in the Boatyard used in the future. For example, community meeting/function space, creative workspace, café/kiosk

Question 7. Do you have other suggestions for features and improvements you would like us to consider as we progress the master plan?

Question 8. What is your age?

- Under 15
- 15-18
- 19-24
- 25-34
- 35-44
- 45-54
- 55-64
- 65-74
- 75+

Question 9. How do you identify?

- Male
- Female
- Non-binary/gender diverse

- Prefer not to say
- Prefer to self-describe

Question 10. What is your primary relationship to Berrys Bay? [tick all that apply]

- I live nearby in Waverton, McMahons Point, Wollstonecraft
- I live in a surrounding suburb: North Sydney, Crows Nest, Lane Cove, Northwood
- I work nearby
- I am part of a recreation club that uses the area
- I am part of a local community group
- I visit the area
- Other / I am interested in future plans for Berrys Bay

Question 11. Are you a person living with a disability?

- Yes
- No
- Prefer not to say

Question 12. Are you of First Nations (Aboriginal or Torres Strait Islander) origin?

- Yes
- No
- Open text

Question 13. Do you speak a language other than English at home? If yes, which language?

- Yes
- No

Which language: Open text

Appendix F – Community update emails



NSW Berrys Bay
GOVERNMENT

Waverton Peninsula

Have your say - Berrys Bay draft master plan

The outlook of Berrys Bay is looking bright after the future vision for part of the Waverton Peninsula was unveiled with the release of the Berrys Bay draft master plan.

Transport has prepared a draft master plan for Berrys Bay and we are seeking your feedback. The master plan will provide a vision to transform the former industrial land of Berrys Bay into usable public open space and the community have an exciting opportunity to shape the future of the site.

We invite the community to have their say on the draft master plan by visiting the interactive portal and providing feedback from now until **Sunday, 23 October**.

If you would like to have your say in person, **two community information sessions** will be held. These sessions will provide further detail regarding the draft master plan, and members of the project team will be available to answer any questions from the community. Information at these sessions will be the same.

- **Location:** Mess Hall, The Coal Loader Centre for Sustainability
- **Address:** 2 Balls Head Drive, Waverton NSW 2060

Session 1

- **Session time:** 4 –7pm
- **Date:** Thursday 13 October 2022

Session 2

- **Session time:** 11am –2pm
- **Date:** Monday 18 October 2022

Please visit the online portal and provide feedback by Sunday, 23 October to have your say.

Have your say now

If you have any questions relating to this survey or generally regarding the Waverton Peninsula, please contact our team at berrysbay@transport.nsw.gov.au.

Figure 13 Public display launch email



Berrys Bay

Waverton Peninsula

Reminder - Have your say on the Berrys Bay draft master plan

Survey closes this **Sunday, 23 October**

In September, Transport announced that we had prepared a draft master plan for Berrys Bay and we are seeking your feedback.

The master plan will provide a vision to transform the former industrial land of Berrys Bay into usable public open space and the community have an exciting opportunity to shape the future of the site.

Community members and stakeholders who have not already done so are being encouraged to 'have their say' on new Berrys Bay draft master plan.

Visit the online portal and provide feedback by Sunday, 23 October 2022 to have your say.

Have your say now

If you have any questions relating to this survey or generally regarding the Waverton Peninsula, please contact our team at berrysbay@transport.nsw.gov.au.

Figure 14 Public display reminder email



© Transport for NSW

Users are welcome to copy, reproduce and distribute the information contained in this report for non-commercial purposes only, provided acknowledgement is given to Transport for NSW as the source.

transport.nsw.gov.au