

Bridge work on Redmayne Road, Horsley Park continues

November 2024



We acknowledge the Dharug people of the Darug Nation as the Traditional Custodians of the lands on which we work and pay respects to Elders past and present.

The M7-M12 Integration project will support future development growth in Western Sydney by improving travel times and congestion. Once complete, the project will provide direct access to commercial and residential hubs, and the new Western Sydney International Airport.

What work are we doing?

Bridge work will continue at the M7 Motorway bridge location over Redmayne Road, Horsley Park between **Friday 1 November** and **Friday 13 December 2024**, subject to approval and weather permitting.

Work will include:

- delivery, mobilisation and demobilisation of plant, equipment, and materials to and from work areas
- construction of pier columns, abutments and headstocks
- girder installation
- concrete pours
- temporary works including scaffolding, barrier removal and installation and road resurfacing
- setting up traffic control.

Road closure and traffic changes

For the safety of road users and our workers, Redmayne Road will be closed between **Friday 1 November** and **Friday 13 December 2024**. Local access to properties and businesses along Redmayne Road will be maintained with traffic diversions in place.

To minimise traffic impact during the bridge deck closure concrete pour at the Villiers Road bridge

location, Redmayne Road will open for public access between **Friday 22 November** and **Sunday 24 November 2024**.

Please refer to the map over the page for alternative routes.

The shared user path along the M7 Motorway leading towards Redmayne Road will remain open.

Safe access to the footpath will be maintained with diversions in place.

There will be temporary traffic changes including alternate full and partial road closures, reduced speed limits and traffic diversions. Road users will be notified of temporary traffic changes via on-site signage and variable messaging system (VMS). Pedestrian and cyclist access will be maintained around the work area.

Please keep to the speed limits and follow the direction of traffic controllers and signs. Traffic control will be in place to assist traffic and pedestrians safely around the work sites.

For the latest traffic updates, you can call 132 701, visit livetraffic.com or download the Live Traffic NSW app.

Our work schedule

Standard work hours are between **7am** and **6pm**, **Monday to Friday** and between **8am** and **6pm** on **Saturdays**.

Our out of hours work hours are between **6pm** and **7am**, from **Monday to Friday** morning and **6pm Friday to 8am Saturday** morning. There will be no work on public holidays. We will not work more than

two (2) nights in a row, three (3) nights in a week and ten (10) nights in a month in the same location.

What equipment will be used?

We will be using vacuum excavation trucks, sawcut and coring machines, drills, air compressors, cranes and lifting equipment, jackhammers, elevated work platforms, chainsaws, excavators, mulchers, compactors, watercarts, profilers, sweepers, light and heavy vehicles, lighting towers, slashers, smooth

drum rollers, padfoot rollers, vibratory rollers, line marking and removal equipment, hand and power tools, concrete pumps, vibrators and trucks, and traffic control equipment.

Managing our impacts

During our work you will see an increase in activity in the area as workers move around the site. Some of our work will be noisy and may generate noise levels similar to a household washing machine.

Location of work area and detour route

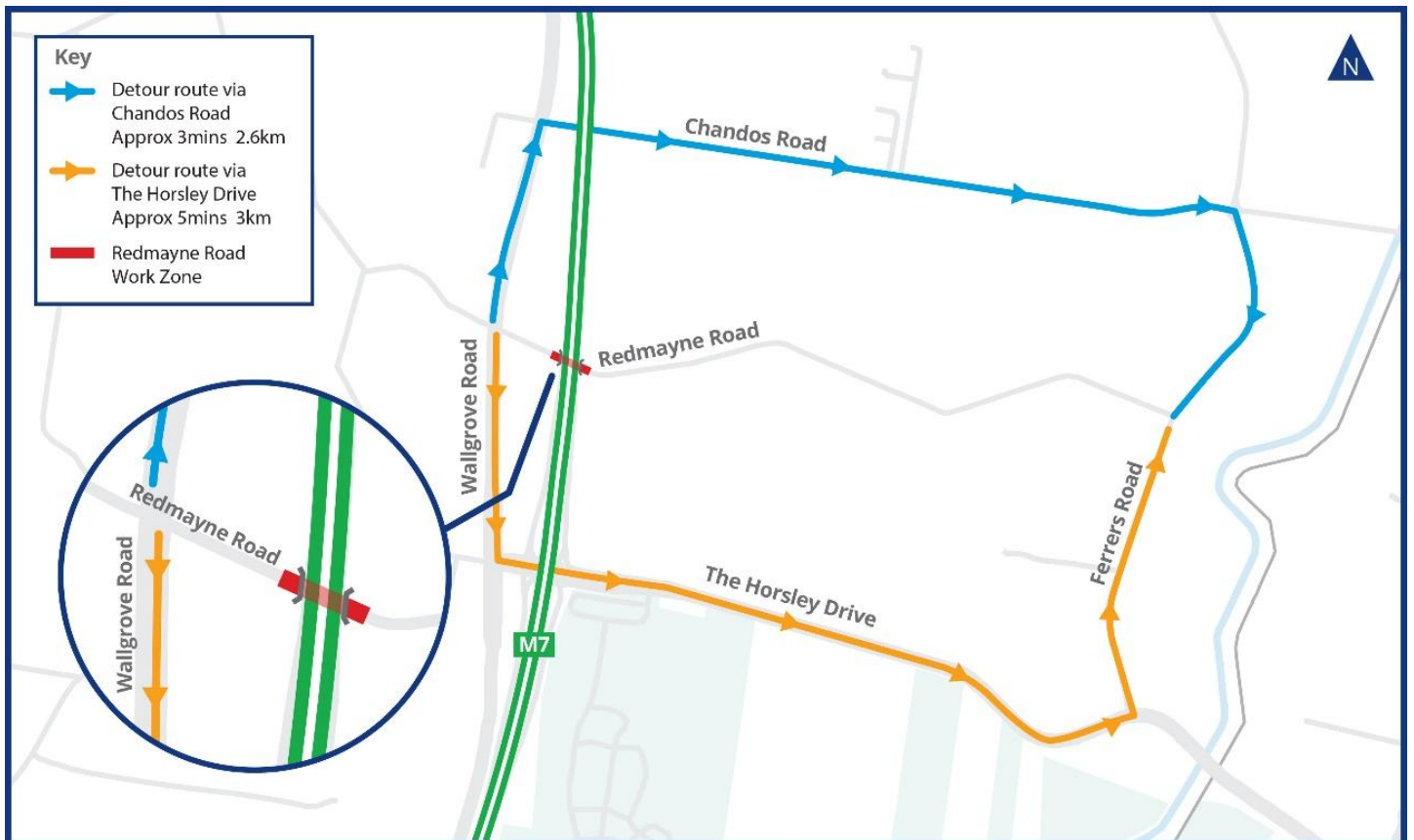

Contact us



24/7 project info line **1800 712 712**



info@m7m12integrationproject.com.au



m7m12integrationproject.com.au



PO Box 98, Kemps Creek NSW 2178



Alternatively, scan the QR code to stay updated

www.transport.nsw.gov.au/privacy-statement#Your_Privacy



Interpreter service

For languages other than English call 131 450
Arabic • Greek • Hindi • Mandarin • Vietnamese

لطلب خدمة الترجمة الشفهية للغات غير الإنجليزية اتصل
بالرقم **131 450**

Για υπηρεσίες διερμηνείας σε άλλες γλώσσες εκτός από
τα Αγγλικά καλέστε το **131 450**

अंग्रेज़ी के अतिरिक्त अन्य भाषाओं के लिए दुभाषिया सेवा
131 450 पर कॉल करें

获取英语以外的其他语言口译协助服务可以致电**131 450**

Để có dịch vụ thông ngôn cho các ngôn ngữ khác tiếng
Anh, gọi số **131 450**