

Bridge work on Saxony Road, Horsley Park

M7-M12 Integration project

July 2024



We acknowledge the Dharug people of the Darug Nation as the Traditional Custodians of the lands on which we work and pay respects to Elders past and present.

The M7-M12 Integration project will support future development growth in Western Sydney by improving travel times and congestion. Once complete, the project will provide direct access to commercial and residential hubs, and the new Western Sydney International Airport.

What work are we doing?

We will carry out bridge foundation work under the M7 Motorway at Saxony Road, Horsley Park adjacent to Wallgrove Road between **Sunday 28 July** and **Wednesday 7 August 2024**.

Work will include:

- establishing work areas including topsoil removal and temporary piling pads installation
- median island removal
- delivery, mobilisation and demobilisation of plant, equipment and materials to and from work areas
- piling
- concrete pours
- setting up traffic control.

To minimise impact to traffic and the local community, work will take place over approximately two weeks. Traffic arrangements in place include full and partial road closures along Saxony Road adjacent to Wallgrove Road (subject to approval and weather permitting).

One lane will reopen each night, **Monday to Friday** between **5pm** and **6am** to allow access.

Please refer to the table below outlining detailed work, lane and road closure schedule:

Start date	Finish date	Closure
10pm Sunday 28 July 2024	4am Sunday 4 August 2024	Full
4am Sunday 4 August 2024	10pm Sunday 4 August 2024	Partial
10pm Sunday 4 August 2024	4am Wednesday 7 August 2024	Full

What equipment will be used?

We will be using a mobile crane, excavator, lighting towers, compactor, piling rig, hand and power tools, concrete truck, delivery trucks, light and heavy vehicles and traffic control equipment.

Traffic changes

There will be temporary traffic changes including alternate full and partial road closures, reduced speed limits and traffic diversions. Road users will be notified of temporary traffic changes via on-site signage and variable messaging system (VMS). The shared user path along the M7 Motorway leading towards Saxony Road will remain open.

Please keep to the speed limits and follow the direction of traffic controllers and signs. Traffic control will be in place to assist traffic and pedestrians safely around the work sites.



For the latest traffic updates, you can call 132 701, visit livetraffic.com or download the Live Traffic NSW app.

Managing our impacts

During our work you will see an increase in activity in the area as workers move around the site. Some of our work will be noisy and may generate noise levels similar to a household washing machine.

Location of work area and detour route

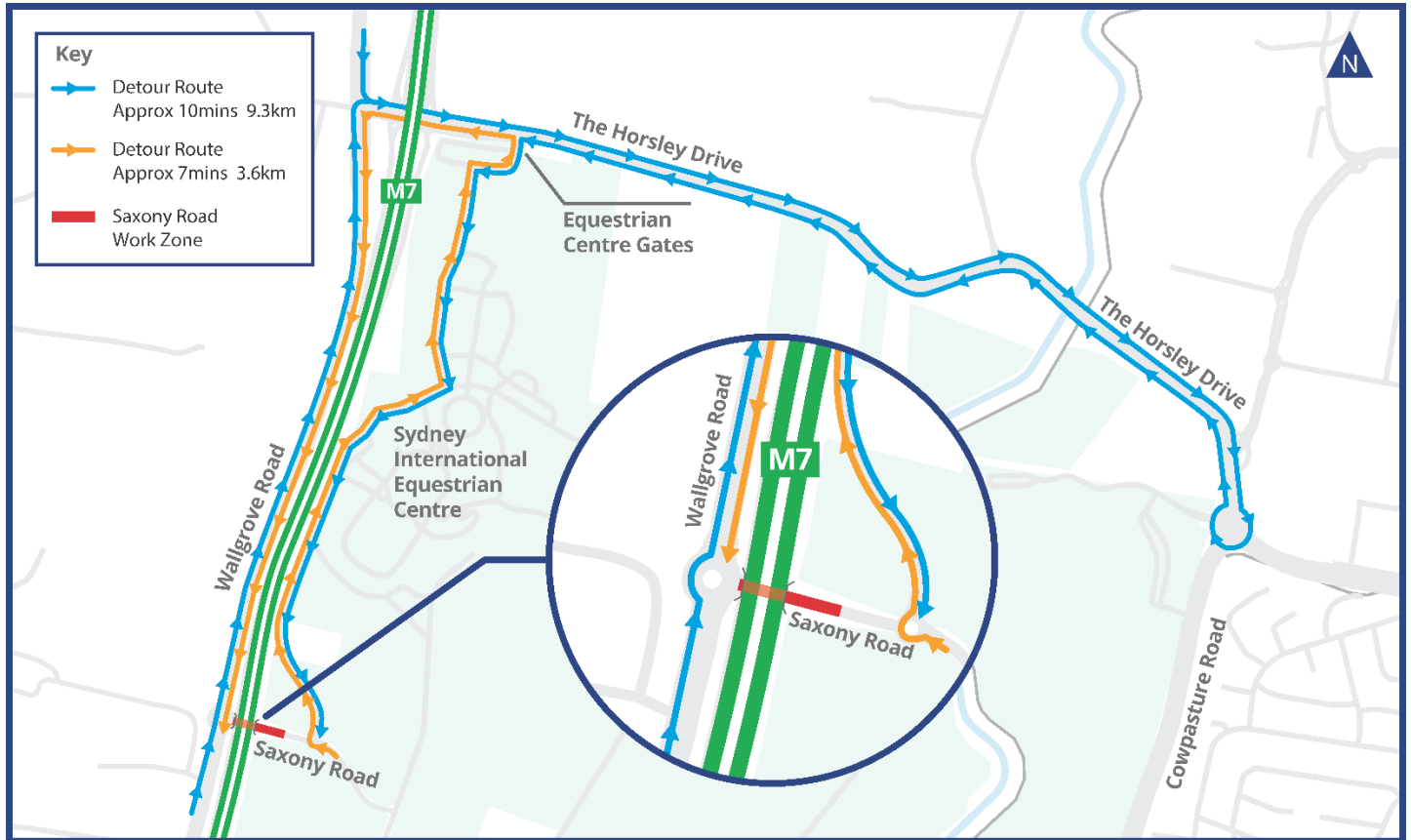

Contact us



24/7 project info line **1800 712 712**



info@m7m12integrationproject.com.au



m7m12integrationproject.com.au



PO Box 98, Kemps Creek NSW 2178



Alternatively, scan the QR code to stay updated

www.transport.nsw.gov.au/privacy-statement#Your_Privacy



Interpreter service

For languages other than English call 131 450
Arabic • Greek • Hindi • Mandarin • Vietnamese

لطلب خدمة الترجمة الشفهية للغات غير الإنجليزية اتصل
بالرقم **131 450**

Για υπηρεσίες διερμηνείας σε άλλες γλώσσες εκτός από
τα Αγγλικά καλέστε το **131 450**

अंग्रेज़ी के अतिरिक्त अन्य भाषाओं के लिए दुभाषिया सेवा
131 450 पर कॉल करें

获取英语以外的其他语言口译协助服务可以致电**131 450**

Để có dịch vụ thông ngôn cho các ngôn ngữ khác tiếng
Anh, gọi số **131 450**