

Closures along M7 Motorway near Hoxton Park Road, Hinchinbrook

M7-M12 Integration project

September 2024



We acknowledge the Dharug people of the Darug Nation as the Traditional Custodians of the lands on which we work and pay respects to Elders past and present.

The M7-M12 Integration project will support future development growth in Western Sydney by improving travel times and congestion. Once complete, the project will provide direct access to commercial and residential hubs, and the new Western Sydney International Airport.

What work are we doing?

We will install bridge girders along the M7 Motorway at Hoxton Park and Wilson Roads, Hinchinbrook between **Wednesday 2 October 2024** and **Friday 13 March 2025**, weather permitting.

Work will include:

- setting up traffic control
- delivering equipment and materials to site work areas
- setting up and packing down equipment
- lifting and installing 92 bridge girders.

Our work schedule

This work will be carried out at night between **9pm** and **5am**, from **Monday** to **Friday**. We will not complete noisy work more than two (2) nights in a row and three (3) nights in a week or ten (10) nights in a month in the same location. These activities will not be carried out during the Christmas shutdown.

What equipment will be used?

We will use cranes, lighting towers, delivery trucks, light and heavy vehicles, trucks, hand and power tools, traffic control equipment and vehicles.

Closures and traffic changes

To reduce traffic impacts and for the safety of our workers and road users, there will be temporary traffic changes, including:

- **M7 Motorway**
Northbound or southbound closures will occur in one direction at any given time between **Cowpasture** and **Benera roads**. All travel lanes will remain open in the opposite direction. We will divert traffic via **Benera, Joadja, Hoxton Park** and **Cowpasture roads**.
- **Hoxton Park Road**
Alternate eastbound and westbound lane closures will be in place between **First Avenue** and **Whitford Road**.
- **Wilson Road**
A full closure will be required between **Hoxton Park Road** and the M7 shared user path. We will divert traffic via **Hoxton Park Road, Whitford Road** and **Frigate-Bird Avenue**.

Please see map over the page for detour routes.

The **Wilson Road** closure and **Hoxton Park** changes will not occur at the same time. Temporary footpath diversions will be in place along Hoxton Park and Wilson roads.

During this work, speed limits will be reduced to **40km/h**.

Pedestrian and cyclist access on to the shared user path along the M7 Motorway will not be impacted.

Detours may direct you on and off the M7 Motorway however you won't incur any additional toll charges.

Road users will be notified of traffic changes via variable message signs (VMS) and on-site signage.

Traffic control will be in place to assist traffic safely around the work sites. Please keep to the speed limits and follow the direction of traffic controllers and signs.

For the latest traffic updates, you can call 132 701, visit livetraffic.com, download the Live Traffic NSW

app or the Linkt app and switch on Road Alerts for M7 roadworks.

Managing our impacts

During our work you will see an increase in activity in the area as workers move around the site. Some of our work will be noisy and may generate noise levels similar to a household washing machine. We will take every possible step to minimise noise, such as scheduling any noisy work earlier in the evening during night work, switching off equipment when not in use and using non-tonal reversing beepers.

Detour routes

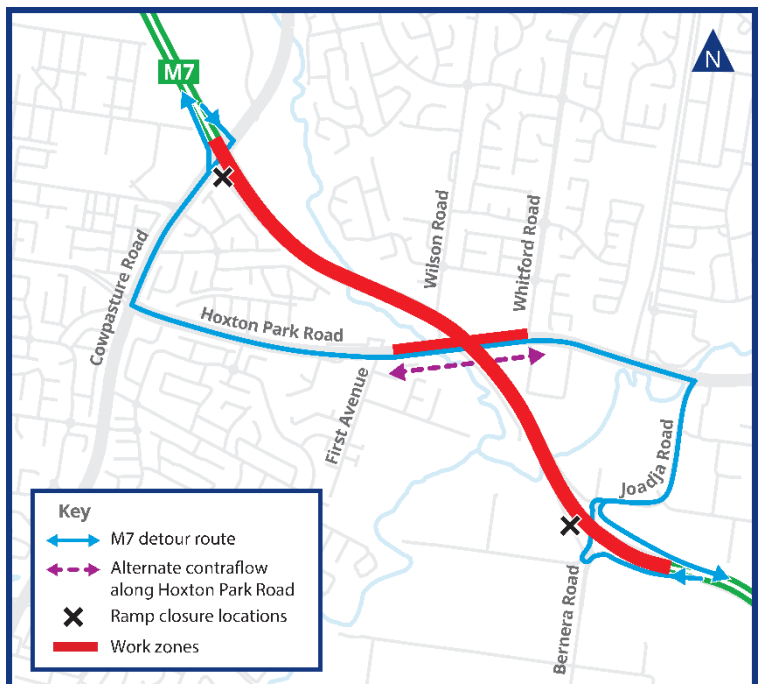
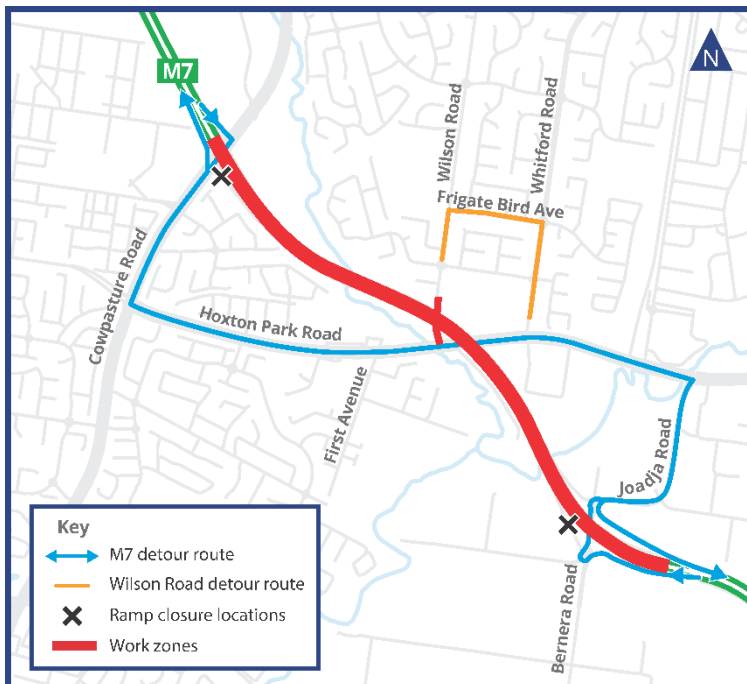

Contact us



24/7 project info line **1800 712 712**



info@m7m12integrationproject.com.au



m7m12integrationproject.com.au



PO Box 98, Kemps Creek NSW 2178



Alternatively, scan the QR code to stay updated

www.transport.nsw.gov.au/privacy-statement#Your_Privacy



Interpreter service

For languages other than English call 131 450
Arabic • Greek • Hindi • Mandarin • Vietnamese

لطلب خدمة الترجمة الشفهية للغات غير الإنجليزية اتصل
بالرقم **131 450**

Για υπηρεσίες διερμηνείας σε άλλες γλώσσες εκτός από
τα Αγγλικά καλέστε το **131 450**

अंग्रेज़ी के अतिरिक्त अन्य भाषाओं के लिए दुभाषिया सेवा
131 450 पर कॉल करें

获取英语以外的其他语言口译协助服务可以致电**131 450**

Để có dịch vụ thông ngôn cho các ngôn ngữ khác tiếng
Anh, gọi số **131 450**