

Closures on M7 Motorway near Cabramatta Creek, Hinchinbrook

M7-M12 Integration project

November 2024



We acknowledge the Dharug people of the Darug Nation as the Traditional Custodians of the lands on which we work and pay respects to Elders past and present.

The M7-M12 Integration project will support future development growth in Western Sydney by improving travel times and congestion. Once complete, the project will provide direct access to commercial and residential hubs, and the new Western Sydney International Airport.

What work are we doing?

We will be installing bridge girders along the M7 Motorway at Cabramatta Creek, Hinchinbrook between **Monday 18 November 2024** and **Thursday 23 January 2025**, weather permitting. Please note, there will be no work during **Saturday 21 December 2024** and **Sunday 5 January 2025**.

Work will include:

- setting up traffic control
- delivering equipment and materials to work areas
- setting up and packing down equipment
- lifting and installation of bridge girders.

Our work schedule

This work will be carried out at night between **9pm** and **5am**, from **Monday** to **Friday**. We will not complete noisy work more than two nights in a row and three nights in a week or ten nights in a month in the same location.

What equipment will be used?

We will use cranes, lighting towers, elevated work platforms, delivery trucks, light and heavy vehicles,

trucks, hand and power tools, traffic control equipment and vehicles.

Managing our impacts

During our work you will see an increase in activity in the area as workers move around the site. This work will generate minimal noise.

Closures and traffic changes

To reduce traffic impacts and for the safety of our workers and motorists, temporary lane, road and ramp closures will be required along the M7 Motorway, near **Benera Road off and on ramps** and between **Benera** and **Cowpasture roads**.

When required, northbound or southbound closures will occur in one direction at any given time. All travel lanes will remain open in the opposite direction.

Please see maps over the page for detour routes.

Detours may direct you on and off the M7 Motorway however you won't incur any additional toll charges.

During these activities, the speed limit will be reduced from **80km/h** to **40km/h**.

Road users will be notified of traffic changes via variable message signs (VMS) and on-site signage.

Pedestrian and cyclist access on to the shared user path along the M7 Motorway will not be impacted.

Traffic control will be in place to assist traffic safely around the work sites. Please keep to the speed limits, plan your journey and follow the direction of traffic controllers and signs.

For the latest traffic updates, you can call 132 701, visit livetraffic.com, download the Live Traffic NSW



app or download the Linkt app and switch on Road Alerts for M7 roadworks.

Detour routes

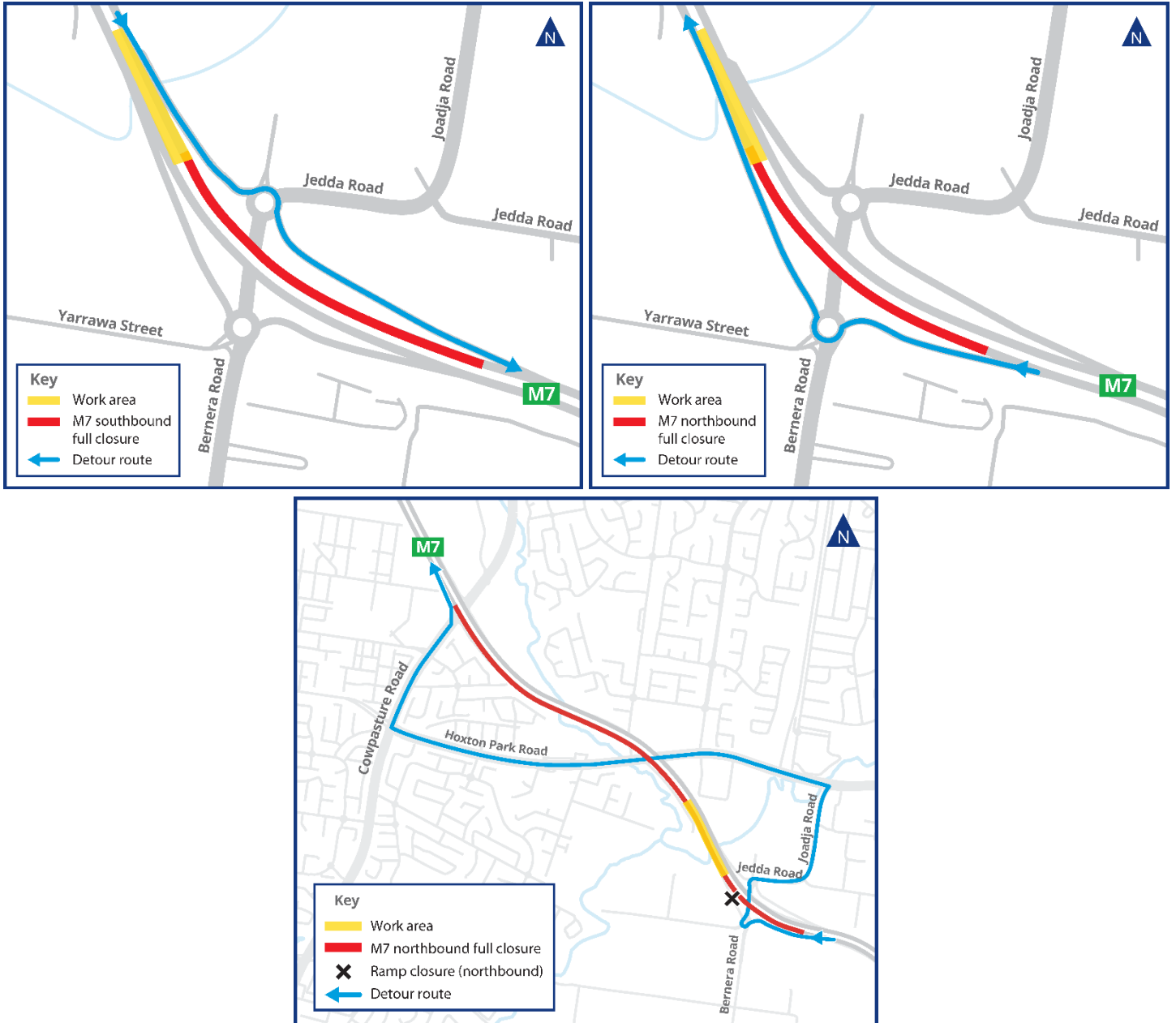

Contact us



24/7 project info line **1800 712 712**



info@m7m12integrationproject.com.au



m7m12integrationproject.com.au



PO Box 98, Kemps Creek NSW 2178



Alternatively, scan the QR code to stay updated



Interpreter service

For languages other than English call 131 450
Arabic • Greek • Hindi • Mandarin • Vietnamese

لطلب خدمة الترجمة الشفهية للغات غير الإنجليزية اتصل
بالرقم **131 450**

Για υπηρεσίες διερμηνείας σε άλλες γλώσσες εκτός από
τα Αγγλικά καλέστε το **131 450**

अंग्रेज़ी के अतिरिक्त अन्य भाषाओं के लिए दुभाषिया सेवा
131 450 पर कॉल करें

获取英语以外的其他语言口译协助服务可以致电**131 450**

Để có dịch vụ thông ngôn cho các ngôn ngữ khác tiếng
Anh, gọi số **131 450**

www.transport.nsw.gov.au/privacy-statement#Your_Privacy