

Bridge Road Works

New Sydney Fish Market

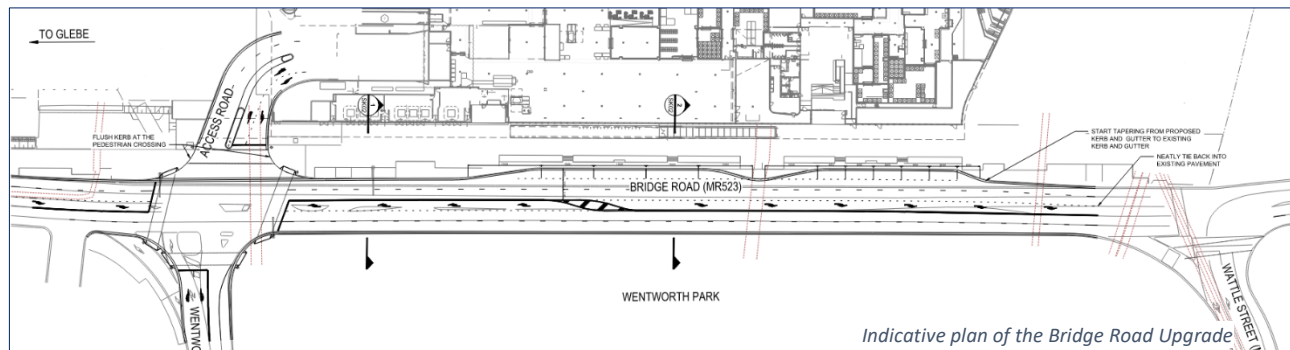

Changes to Bridge Road

A section of Bridge Road between Wentworth Park Road and Wattle Street will be adjusted and reconfigured to provide streamlined access to the new Sydney Fish Market. The localised widening of Bridge Road will deliver:

- improved safety with widened footpath areas
- bus and taxi drop-off and pick-up areas
- improved traffic, pedestrian, and cyclist management.

The Wentworth Park Rd intersection will provide access for vehicles to enter the market by establishing signalised traffic and pedestrian crossings.

Traffic management along Bridge Rd will be improved with an extended righthand turn lane into Wattle St, services and utilities will be relocated underground and stormwater drainage will be improved.



Artists render of upgraded Bridge Road and the new Sydney Fish Market

Stage One works will involve:

- Underground relocation of existing services and utilities to within the site boundary

For more information about the new Sydney Fish Market:
Visit newsydneyfishmarket.nsw.com
Email nsgm.community@multiplex.global
Call 1800 271 114

- Reconfiguration of the Wentworth Park Road and Bridge Road intersection.

The work will be undertaken at the intersection of Bridge Rd with Wattle St and with Wentworth Park Rd. The work will be a combination of day works, night works and weekend works.

Subsequent works will involve:

- adjustments to Bridge Rd to allow for a bus and taxi lane
- finishing works such as line marking, traffic signals and signage.

Work Schedules

Work has started in September 2023 and will take several months. The work will be a combination of day, night and weekend works. Some of this work will be undertaken within a delineated work zone at the corner of Bridge Rd Wentworth Park Rd.

Impacts and mitigation

- Traffic access will be maintained along Bridge Rd
- Traffic controllers will safely guide vehicles, cyclists, and pedestrians around works zones
- Night works will be limited to 2 nights per week at each work zone to provide 5 nights respite
- The noisiest works will be undertaken prior to 12am where reasonable and feasible
- Measures will be in place to limit noise on site,

We acknowledge the impacts this work may have and thank the community and road users for their patience and understanding.

For help understanding this information, please contact 131 450 and ask them to call 1800 271114

