

# We're building a non-stop South Road

June 2025

## Power line decommissioning works, Mile End

Day and night works are required as part of continued site establishment works at various locations between Sir Donald Bradman Drive and London Road, Mile End.

## What's happening

Day and night works will be undertaken on South Road and local side streets, between Sir Donald Bradman Drive and London Road, Mile End from **Wednesday 11 June**, for approximately six weeks, weather permitting.

The work will involve decommissioning of existing power lines and trenching for the installation of new electrical conduits.

## How this affects you

Short term speed and lane restrictions and pedestrian detours may be required during the works. Signage and traffic controllers will be in place to ensure motorists, cyclists and pedestrians can safely navigate around our work areas.

If temporary access to your driveway will be affected, you will be notified in advance. Some disturbances can be expected such as noise, dust and vibration, however construction crews will work to keep disruption to a minimum.

**Some short-term power outages may be required to facilitate these works. SA Power Networks will directly notify affected properties in advance.**

### When

From Wednesday 11 June 2025 for approximately six weeks, weather permitting

### Hours of work

Night works between 7pm and 6am, Monday to Sunday.

Day works between 7am and 7pm, Monday to Friday.

### Where

South Road and local side streets, between Sir Donald Brandman Drive and London Road

### More information

Visit [T2D.sa.gov.au](https://T2D.sa.gov.au)

Email [info@T2Dalliance](mailto:info@T2Dalliance)

Call 1300 951 145



Two tunnels with three lanes in both directions



Saving drivers up to 40 minutes in peak hour



Supporting 5500 jobs



Australian Government

**BUILDING AUSTRALIA**



Government  
of South Australia  
Department for Infrastructure  
and Transport

**SA IS  
BUILDING**  
→

Delivered by

**TORRENS TO  
DARLINGTON  
ALLIANCE**

## Work locations

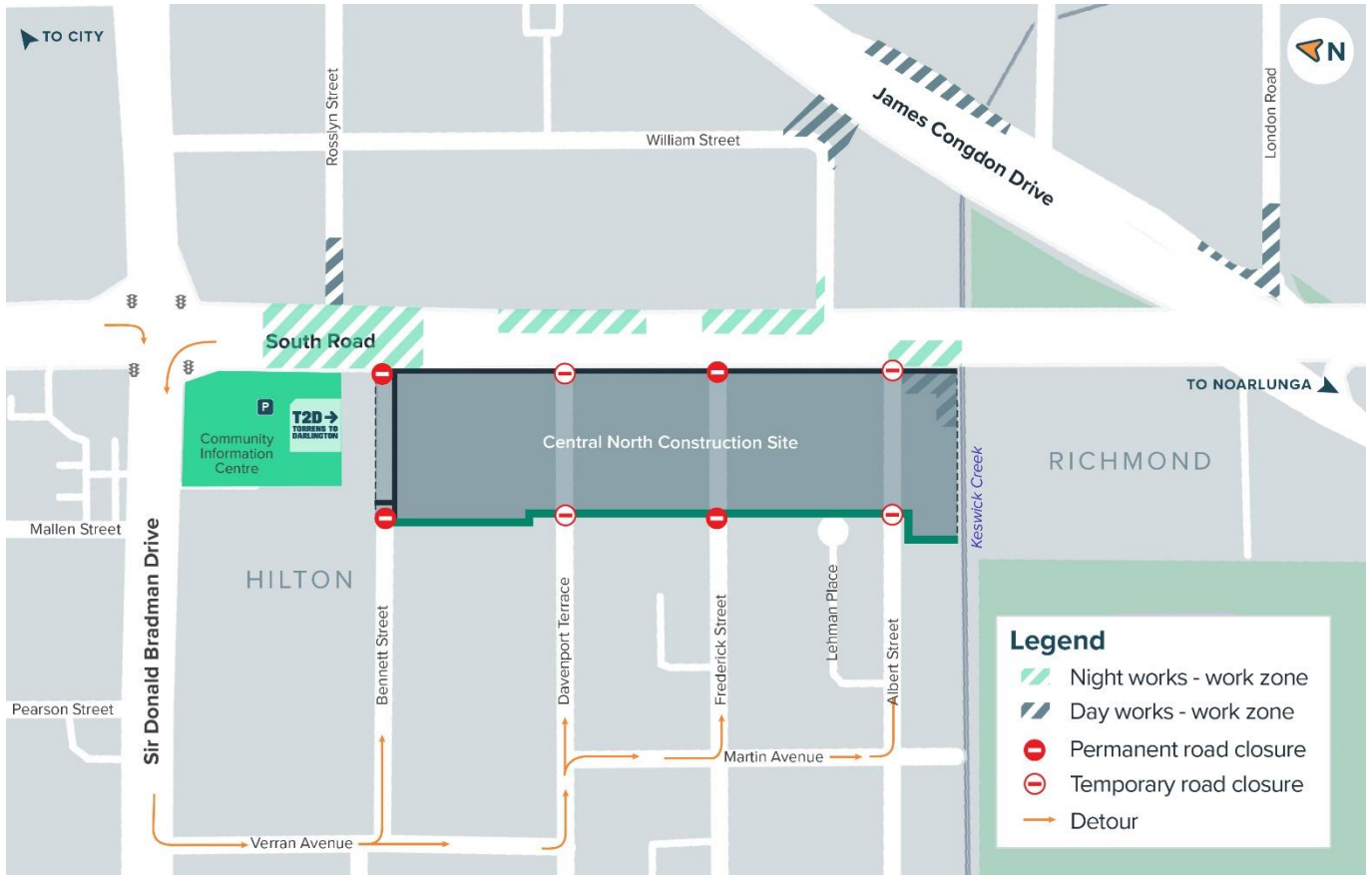

## Stay informed

If you have any questions, please contact us on 1300 951 145 or visit [T2D.sa.gov.au](http://T2D.sa.gov.au).

If you would like to receive SMS or email updates, please register your details using the QR code.

