

# Your guide to the draft Place, Design and Landscape Plan for Berrys Bay

Western Harbour Tunnel

July – August 2025

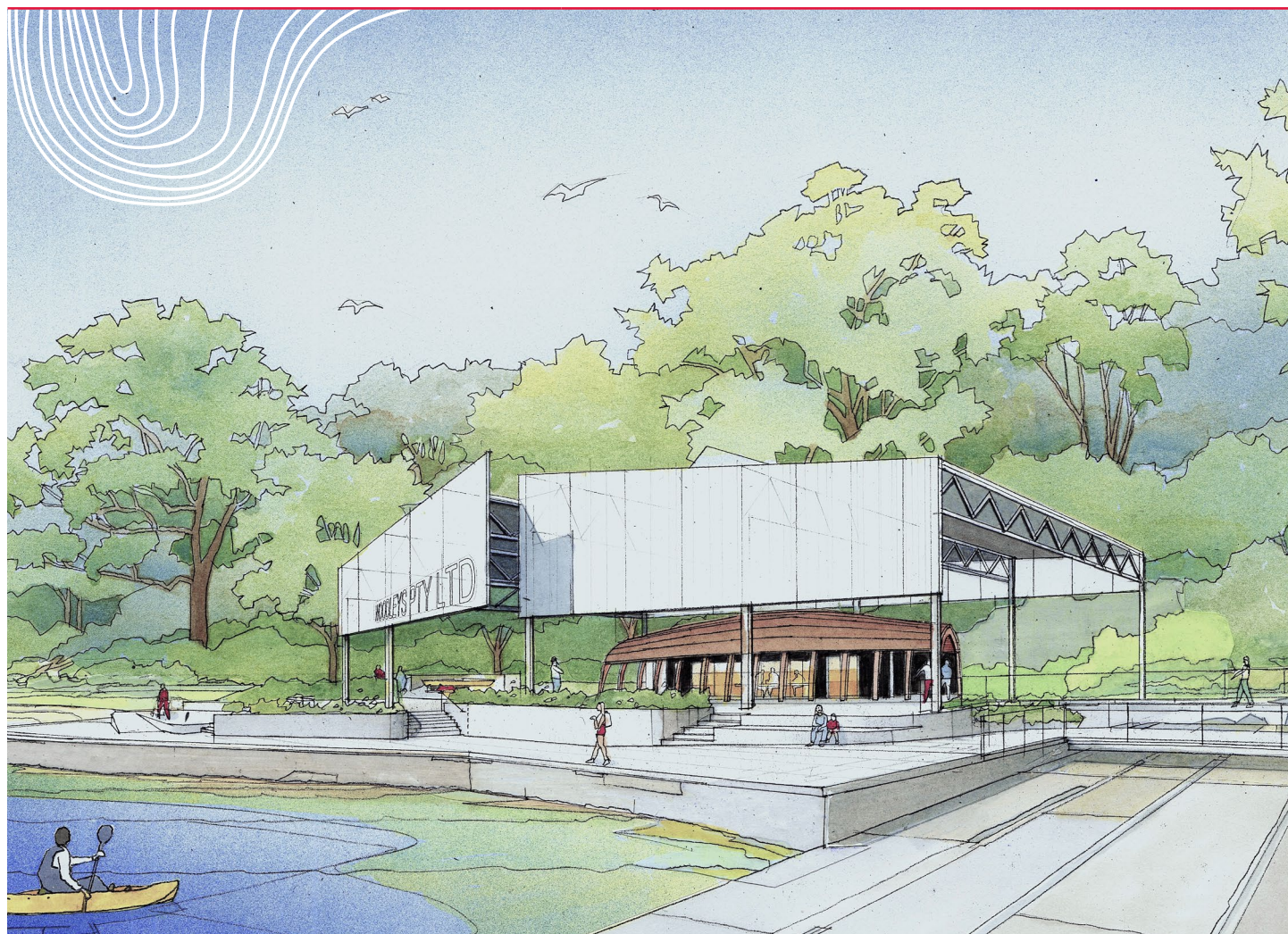

To understand the proposed design elements and considerations that make up the draft Berrys Bay Place, Design and Landscape Plan (PDLP), we've created this community guide to accompany the draft plan and outline how to have your say.



We acknowledge the Traditional Custodians of the Country on which Western Harbour Tunnel is being constructed, including the Gadigal, Cammeraygal, and Wangal peoples, as well as the Aboriginal peoples of Emu Plains, and we pay respect to Elders past and present.





**Western Harbour Tunnel (WHT) will make it easier, faster and safer to get around Sydney.**

**With the change in the tunnelling methodology under Sydney Harbour, the foreshore land at Berrys Bay Waverton is no longer required as a temporary construction site. The site will be returned to the community as new foreshore parkland by Transport for NSW (Transport) with delivery partner, ACCIONA.**

At Berrys Bay, our vision is to contribute to the community, by giving back in meaningful ways through new open spaces and landmark features that respect and acknowledge the Country they are built on.

As part of the design process, we are inviting you to provide feedback on the draft PDLP for Berrys Bay.

## What is the WHT PDLP?

The WHT PDLP outlines how public spaces connected to the WHT project will look, feel and function once construction is complete. The PDLP outlines the design development process and reflects the historical and cultural significance of the area, including connection to Cammeraygal Country.

The PDLP is a requirement under the WHT project's Conditions of Approval. It is presented in three parts. Each part has its own key objectives and is being consulted on separately as outlined below.

## WHT PDLP (Part 1) – Critical tunnel infrastructure and in-tunnel public art

WHT PDLP (Part 1) was approved by the Department of Planning, Housing and Infrastructure (DPHI) on 10 June 2025. The approved WHT PDLP (Part 1) can be viewed at [nswroads.work/wht](https://nswroads.work/wht)

## WHT PDLP (Part 2) – Berrys Bay < we are here

The draft PDLP for Berrys Bay is open for community and stakeholder feedback until midnight on **Sunday 24 August 2025**.

## WHT PDLP (Part 3) – Cammeray Parkland

The final part of the WHT PDLP (Part 3) – Cammeray Parkland is in the early planning stage. Located between Warringah Freeway and Cammeray Golf Course, the new public open space will be returned to the community after construction of WHT.



Explore the Berrys Bay PDLP online interactive map at [nswroads.work/wht-pdlp2](https://nswroads.work/wht-pdlp2)

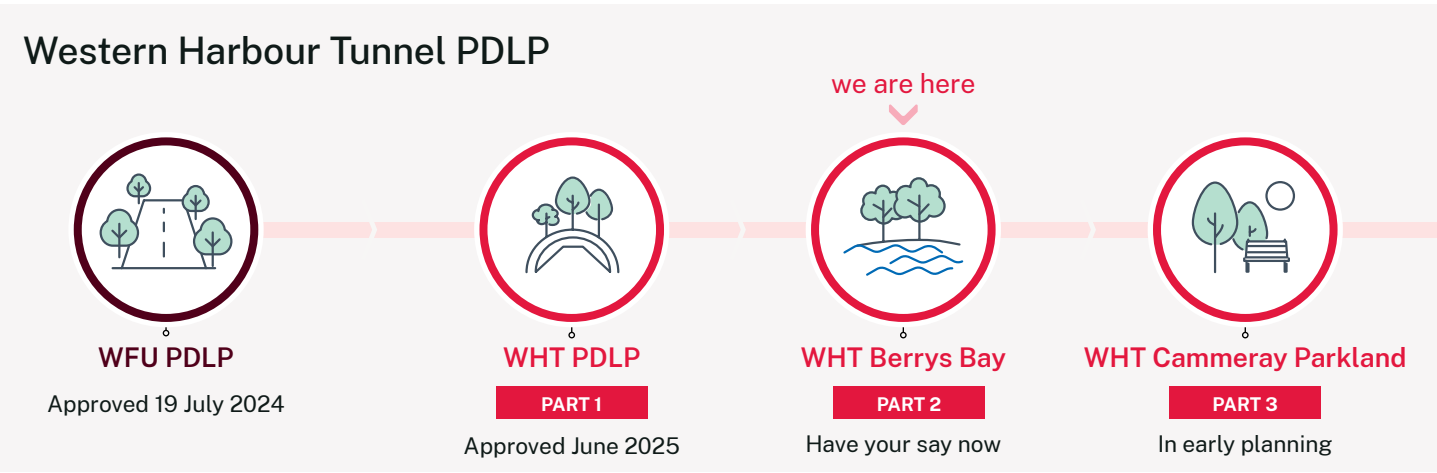

**Above diagram:** The project's PDLP staging is in three parts.

**Front image:** Artist's impression - Reimagining of Woodley's Shed as a community pavilion, view from harbour.



# What is in the draft WHT PDLP (Part 2) – Berrys Bay?

We recognise the Berrys Bay foreshore parkland presents a significant opportunity to return previously derelict land to the community, reshaped as accessible open spaces, community facilities and improved connection to water for future generations to enjoy.

The draft PDLP includes proposed designs for playground facilities, accessible continuous foreshore pathways, picnic areas and native landscaping. The draft PDLP also outlines a signage strategy to navigate throughout the parkland, linking storytelling opportunities and interpretation of heritage items.

The Woodley's Shed main building is being reimagined as a new community pavilion, honoring the rich layers of history at Berrys Bay, including a century of boatbuilding at the site.

The draft PDLP outlines the design journey as it has evolved, including design considerations and opportunities. In planning for the future use of Berrys Bay, we have worked closely with North Sydney Council and other stakeholders to shape the proposed design, including co-design opportunities.

Community feedback has guided the design process from the start.



## Did you know?

Woodley's Boatyard was established in 1906 at Berrys Bay after relocating from Millers Point.



Artist's impression - view towards the entry walk, looking north towards Balls Head Road



Artist's impression - view of the foreshore walk, looking east



Artist's impression - view from within the bund play and picnic area looking towards Sydney Harbour



# Berrys Bay foreshore parkland - Design features



# What can I provide feedback on?

Certain design elements are not subject to community feedback, as they have been designed in accordance with strict engineering or technical requirements that must be adhered to during the design process.

We are seeking community feedback on select elements of the proposed design, including:

- play facilities
- park facilities such as the picnic spaces, seating, connection to water and pathway connections (including materials and finishes)
- Woodley's Shed, reimaged as a new community pavilion, with outdoor covered spaces and indoor space design (including materials and finishes)
- landscape design, including the type and location of plants.

North Sydney Council proposes to undertake separate community engagement on the future use of the Woodley's Shed community facility being delivered by Transport. The building is envisaged to play a key role in supporting the parkland, including hosting community events like entertainment and markets, and be available for hire and Council-run programs. This is separate to the WHT PDLP consultation process.

## How do I provide feedback?

To have your say, please visit the PDLP project website at [nswroads.work/wht-pdlp2](https://nswroads.work/wht-pdlp2) or by emailing the project directly at [whtbl@transport.nsw.gov.au](mailto:whtbl@transport.nsw.gov.au)

You can also view a copy of the draft PDLP and provide feedback in person by visiting our Community Information Centre, between Monday to Friday, 9am to 5pm at Level 9, 60 Miller Street, North Sydney.

## Come and meet us

Details of our community information sessions are:

Location	Date	Time
<b>Online information session</b> Registration required – details below	<b>Wednesday 6 August 2025</b>	<b>12:00pm to 1:00pm</b>
<b>In-person information session</b> WHT Community Information Centre Level 9, 60 Miller Street, North Sydney (step-free accessible building) Registration required – details below	<b>Thursday 7 August 2025</b>	<b>5:30pm to 6:30pm</b>
<b>Pop up stall at Coal Loader, Centre for Sustainability</b> Weather permitting location at the café, indoors if raining.	<b>Saturday 9 August 2025</b>	<b>10:00 to 12:30pm</b>
<b>Pop up stall at Northside Produce Markets</b> Ted Mack Civic Park, North Sydney	<b>Saturday 16 August 2025</b>	<b>9:00am to 12:00pm</b>

## Register to attend an information session

To register for the sessions visit: [nswroads.work/wht-pdlp2](https://nswroads.work/wht-pdlp2) or scan the QR code.

Please register for online session before **5pm on Tuesday 5 August 2025** to receive the link to join online. At the session, you'll hear about key elements of the draft PDLP and can submit questions during the online session. The session will be recorded and available on the project website after the event, so you can watch it at a time that suits you.



In Person



Online



# Who is the WHT delivery partner?

ACCIONA (Australia and New Zealand) is Transport's WHT delivery partner, who is helping to deliver the transformation of derelict industrial land at Berrys Bay into a new foreshore parkland, as part of the WHT project. ACCIONA is guided by strong social and sustainability goals, including reducing waste, restoring the environment, creating local jobs, supporting diverse and inclusive communities.

## What happens next?

All submissions received from the community and stakeholders during the public exhibition period will be carefully reviewed and considered in shaping of the final design. The WHT PDL (Part 2) - Berrys Bay will then be submitted to the Department of Planning, Housing and Infrastructure (DPHI) for approval, in accordance with the WHT project's Conditions of Approval.

While this process will inform the final build elements of the parkland and new community pavilion, early construction activities - including site establishment and building removal will occur in the meantime.

## Stay informed

We will continue to provide progress on the project via email, community notifications, via the WHT Berrys Bay website and our interactive construction map portal. To stay informed, please subscribe to the 'Future use of Berrys Bay' email list through the QR code below.

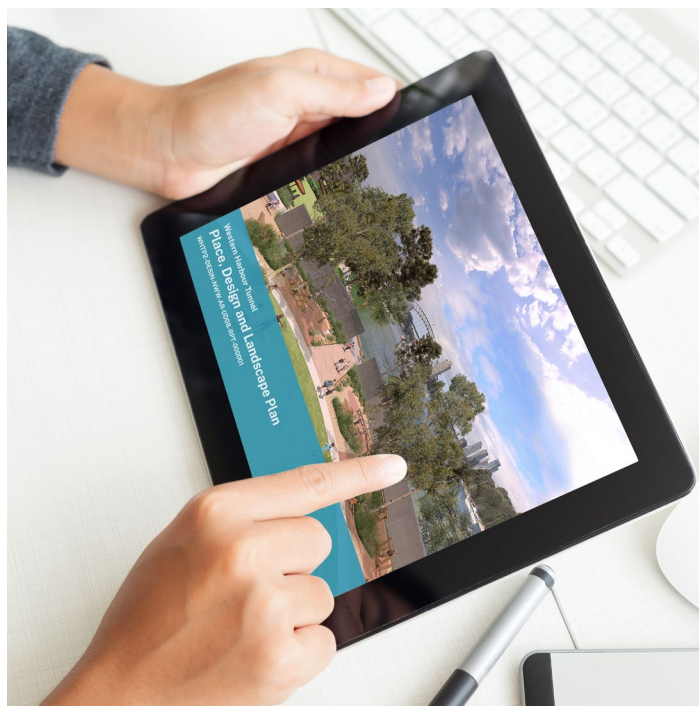

## Watch the vision take shape



Discover how the Berrys Bay project is bringing derelict land by the water's edge to life. From its deep Cammeraygal roots and industrial past to a vibrant, connected open space for generations to come. Explore the design journey that reinterprets history and reimagines the future. Visit [nswroads.work/wht-pdlp2](https://nswroads.work/wht-pdlp2)

## Contact us



Project Infoline **1800 931 189**  
(ask for Western Harbour Tunnel Stage 2)



[whtbl@transport.nsw.gov.au](mailto:whtbl@transport.nsw.gov.au)



Western Harbour Tunnel  
PO Box 537  
North Sydney, NSW, 2059, Australia



Visit our website at  
[nswroads.work/whtportal](https://nswroads.work/whtportal)



### Interpreter service

For languages other than English call **131 450**  
Arabic • Greek • Hindi • Mandarin • Vietnamese

لطلب خدمة الترجمة الشفهية للغات غير الإنجليزية اتصل  
بالرقم 131 450

Για υπηρεσίες διερμηνείας σε άλλες γλώσσες εκτός από  
τα Αγγλικά καλέστε το **131 450**

अंग्रेज़ी के अतिरिक्त अन्य भाषाओं के लिए दुभाषिया सेवा  
**131 450** पर कॉल करें

获取英语以外的其他语言口译协助服务可以致电**131 450**

Để có dịch vụ thông ngôn cho các ngôn ngữ khác tiếng  
Anh, gọi số **131 450**



Sign up for emails

[www.transport.nsw.gov.au/privacy-statement#Your\\_Privacy](https://www.transport.nsw.gov.au/privacy-statement#Your_Privacy)